

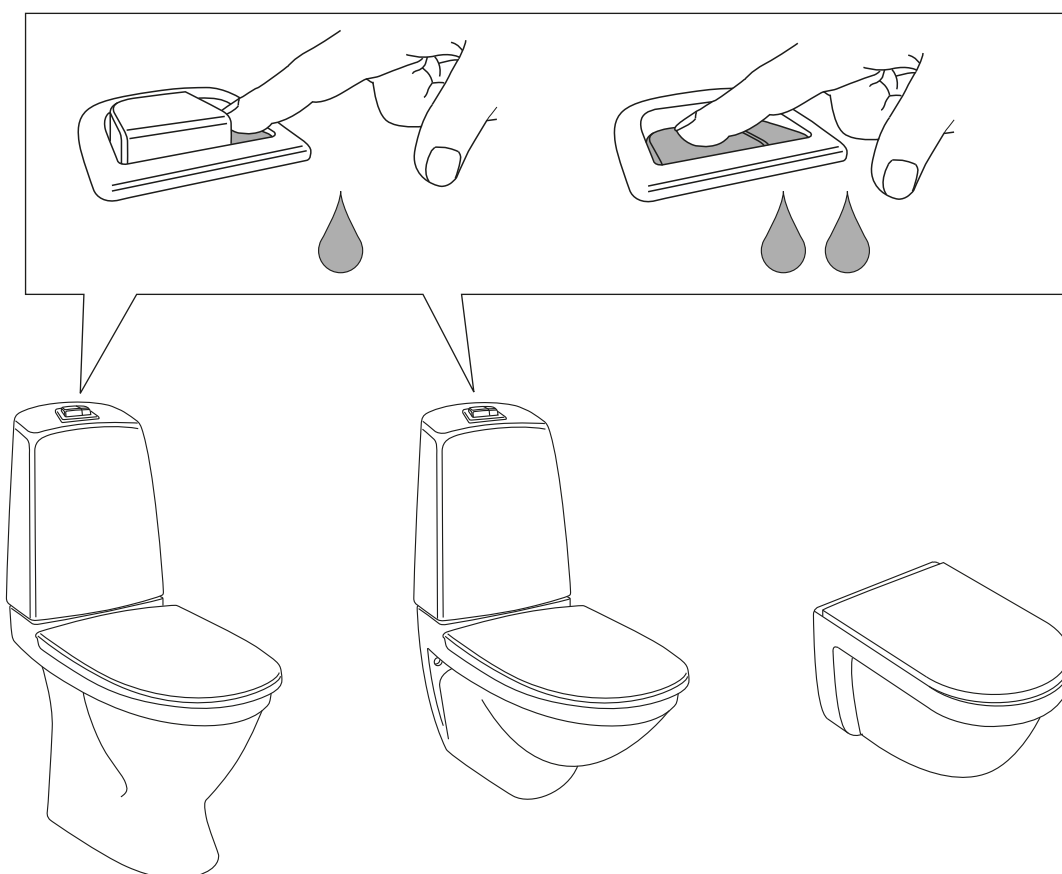

SE	MONTERINGSANVISNING NAUTIC WC
DK	MONTERINGSVEJLEDNING NAUTIC WC
NO	MONTERINGSANVISNING NAUTIC WC
FI	ASENNUSOHJE, NAUTIC WC
GB	INSTALLATION INSTRUCTIONS NAUTIC WC
EE	PAIGALDUSJUHENDID NAUTIC WC-DELE
LV	UZSTĀDĪŠANAS INSTRUKCIJA NAUTIC WC
LT	NAUTIC UNITAZO MONTAVIMO INSTRUKCIJA

2017 →



CE



Accepterad  
monteringsanvisning  
2026:1



	Garanti. Takuu. Guarantee. Garantii. Garantija. Garantija.	3/22
	Nautic 1500. 1546. 5500. 1510. 5510. 1591. 1596. 1591WL & 1596WL	4/22
	Nautic 1546. 1591 & 1596	5/22
	Nautic 1500. 1510. 1546. 1591. 1596. 5500 & 5510	5/22
	Nautic 1591WL. 1596WL	6/22
		7/22
	Nautic 5530	8/22
	Nautic 1530	9-10/22
	Nautic 1522	11/22
	Service. Tjeneste. Huolto. Hooldus. Techninė pagalba. Pakalpojums.	12-21/22
	9M26S101. 9M26S136. 8M45S101. 9M256101. 8M916101. 8M91S101. 8M93S101 & 8M93S115.	21/22
	Reservdelar. Reservedeler. Reservedele. Varaosat. Spare parts. Varuosad. Atsarginės dalys. Rezerves daļas.	22/22
	Drift & skötsel Drift og vedligeholdelse Drift og vedlikehold Asennus-, käyttö- ja hoito-ohjeet Assembly and maintenance Paigaldamine & hooldamine Montaza un kopsana Montavimas ir priežiūra	22/22

## SE GARANTI

Produkten har garanti enligt respektive lands gällande branschvillkor.

Direktiv vid reklamation.

Våra produkter är tillverkade enligt väldigt stränga kvalitetskrav. Om en produkt trots det är felaktig, ber vi er i första hand att kontakta din återförsäljare. Ärendet underlättas genom att uppvisa kvitto och uppge produktnummer och inköpsdatum.

## DK GARANTI

Produktet har garanti i forhold til gældende dansk lovgivning.

Vejledning ved reklamation.

Vores produkter er fremstillet i overensstemmelse med markedets strengeste krav til kvalitet. Skulle produktet mod forventning være behæftet med fejl henviser vi til den forhandler, hvor produktet er købt. Kvittering skal kunne fremvises, hvis forhandleren forlanger det, ligesom oplysninger om produktnummer og købsdato skal kunne dokumenteres.

## NO GARANTI

Produktene har garanti i henhold til respektive lands gjeldende bransjevilkår.

Instrukser ved reklamasjon.

Våre produkter er produsert i henhold til veldig strenge kvalitetskrav. Om et produkt til tross for dette skulle være feilaktig, ber vi deg vennligst ta kontakt med forhandleren. Vi ber deg medbringe kvittering og oppgi innkjøpsdato samt produktnummer.

## FI TAKUU

Noudatamme alamme yleisiä toimitusehtoja.

Reklamaatio.

Tuotteemme ovat valmistettu Villeroy & Boch ja Gustavsbergin laatuvaatimuksien mukaisesti. Mikäli tuote kuitenkin on virheellinen pyydämme teitä kääntymään ensisijaisesti tuotteen myyjän puoleen. Käsittelyn helpottamiseksi säilyttäkää tosite tuotteen ostosta.

## GB GUARANTEE

The product has a guarantee accordingly to industry rules in every country.

Instructions for complaints.

Our products are made according to very strict quality demands. If the product is faulty in spite of that we ask you kindly to take it to your reatailer. We also ask you to bring the receipt and be prepared to inform about the product number and purchasing date.

## EE GARANTII

Antud tootel on garantii vastavalt tehase poolt kehtestatud tingimustele.

Juhised reklamatsioonide käsitlemiseks.

Meie tooted on valmistatud silmas pidades väga täpseid kvaliteedistandardeid. Juhul kui olete saanud praaktoote, palume Teil toimetada see kas meie edasimüüja juurde või võtta ühendust esindusega. Samuti palume alles hoida ostutšekk ning vajadusel anda informatsiooni tootenumbri ja ostu sooritamise aja kohta.

## LV GARANTIJA

Izstrādājumam ir garantija saskaņā ar ražotāja standartiem.

Instrukcija kvalitātes problēmu gadījumā.

Mūsu produkcija tiek ražota pēc ļoti striktiem kvalitātes kritērijiem. Taču – gadījumā, ja produktam tiek konstatēta kvalitātes problēma – lūdzu, sazinieties ar pārdevēju. Lūdzu, esiet gatavi arī uzrādīt pirkuma čeku ar pirkuma datumu.

## LT GARANTIJA

Gaminiams garantija suteikiama atsizvelgiant i , konkrečios šalies kokybės reikalavimus.

Reklamacijos.

Mū su , produkcija pagaminta vadovaujantis griežtais kokybės reikalavimais. Jei gaminys nekokybiškas – prašome ji , gra , žinti pardavėjui, pateikiant pirkimo čeki , , gaminio numerį , bei nurodant pirkimo data , .



NAUTIC 1500.  
1546 & 5500

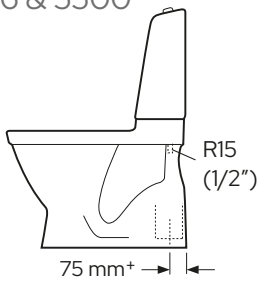

NAUTIC 1510 &  
5510

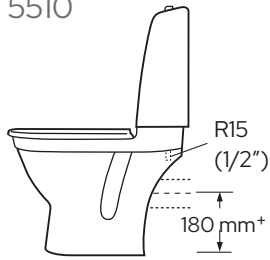

NAUTIC 1591.  
1596

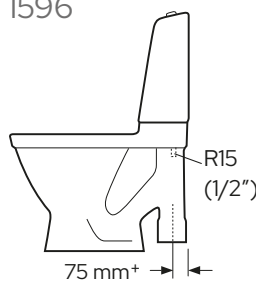

NAUTIC 1591WL  
& 1596WL

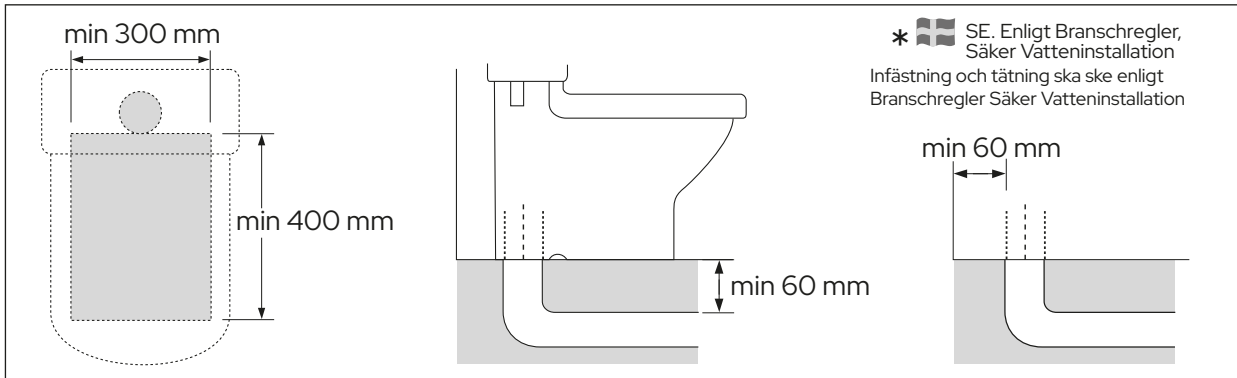
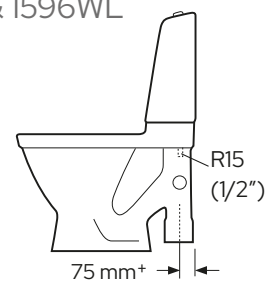

NAUTIC 1500. 1510.  
5500 & 5510

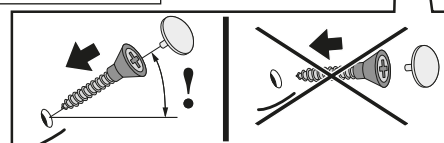
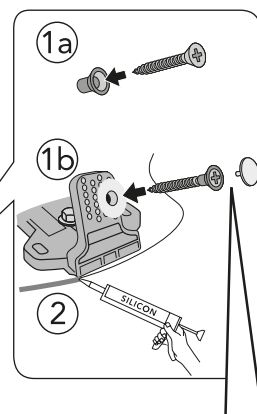
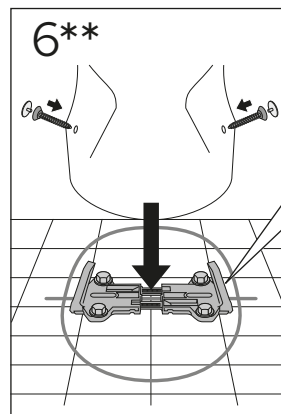
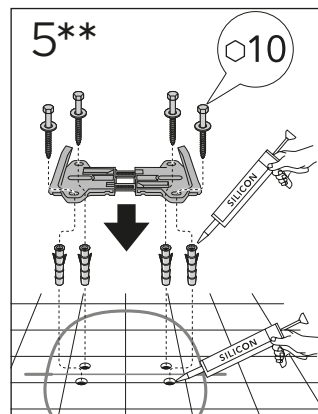
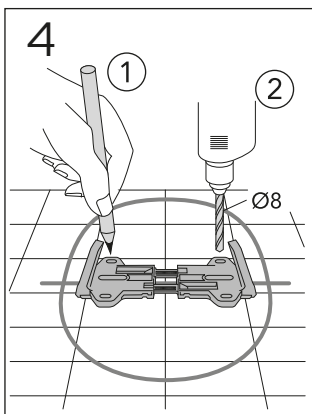
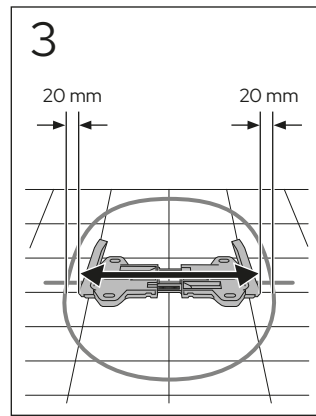
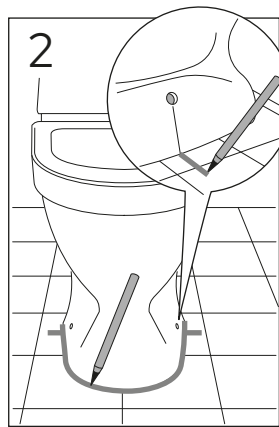
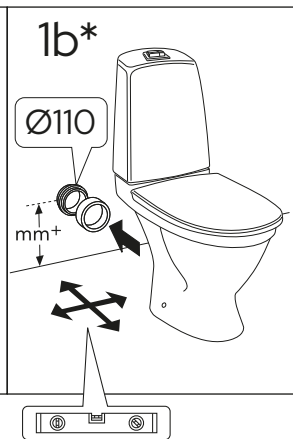
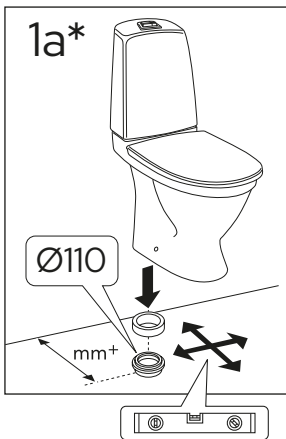
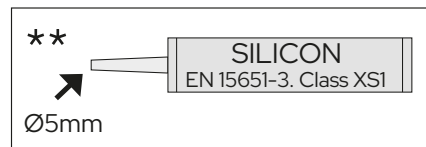



NAUTIC 1546. 1591 & 1596

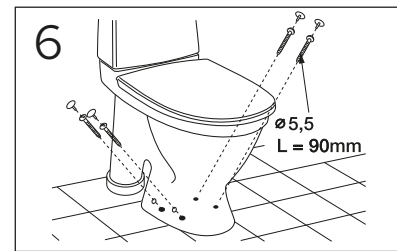
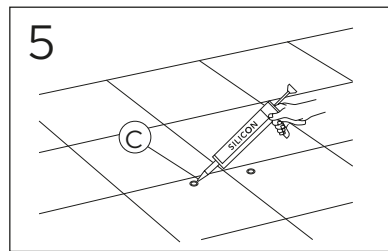
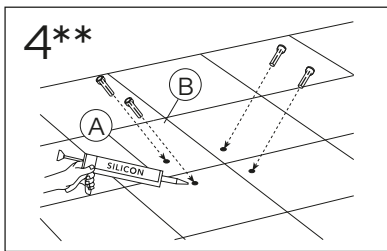
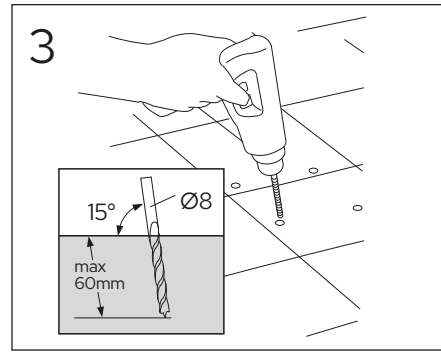
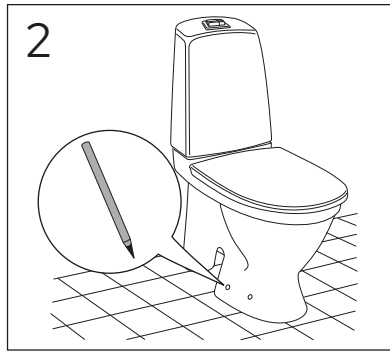
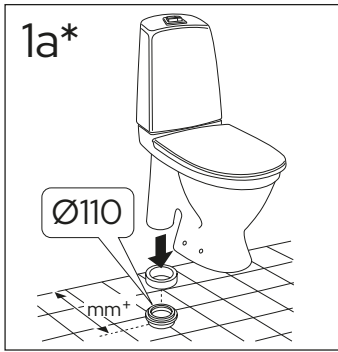
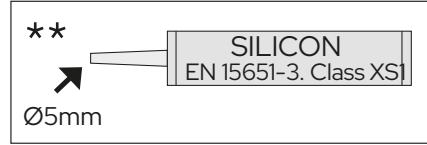

NAUTIC 1500. 1510. 1546. 1591. 1596. 5500 & 5510

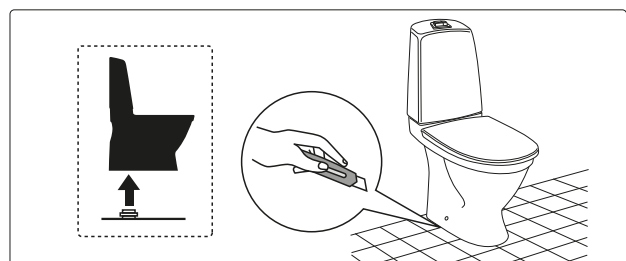
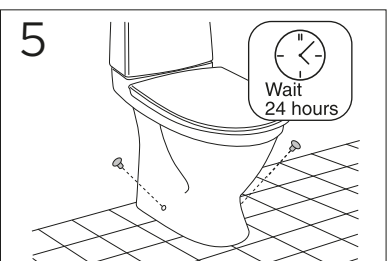
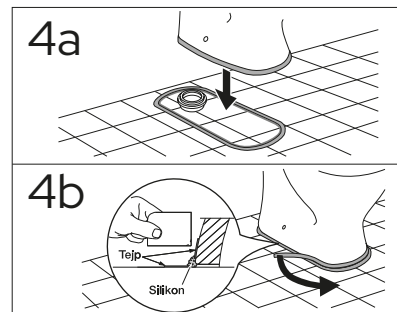
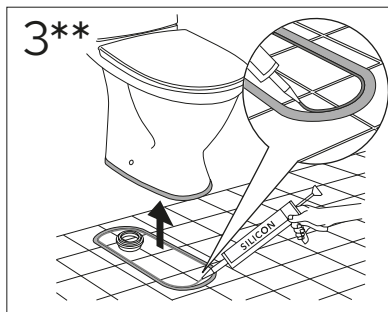
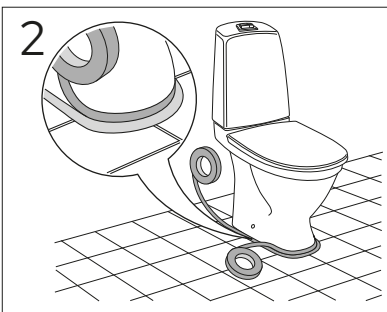
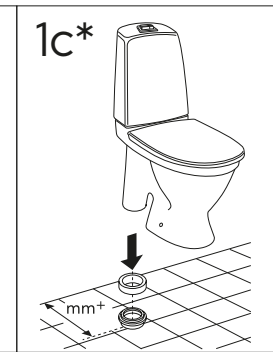
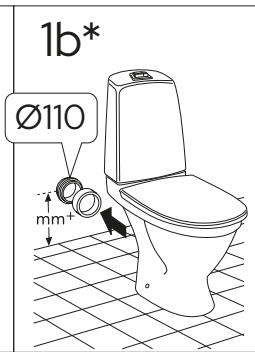
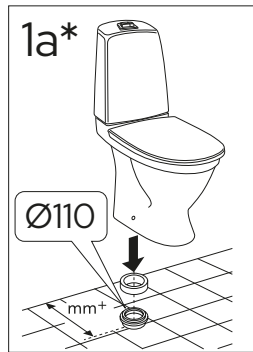
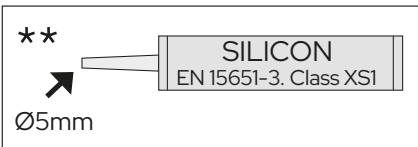



# NAUTIC 1591WL. 1596WL

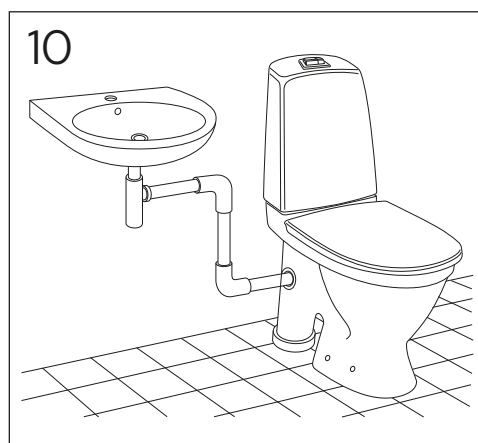
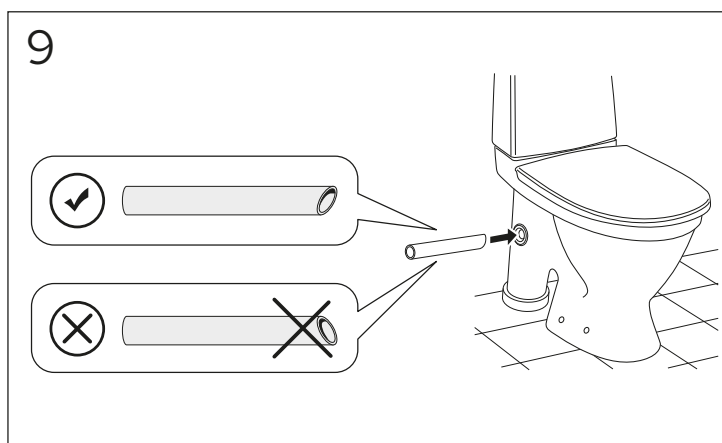
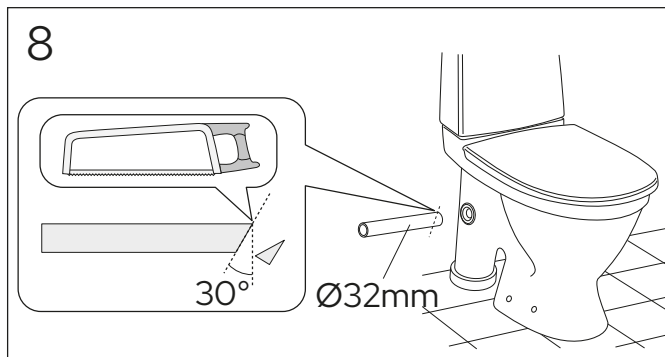
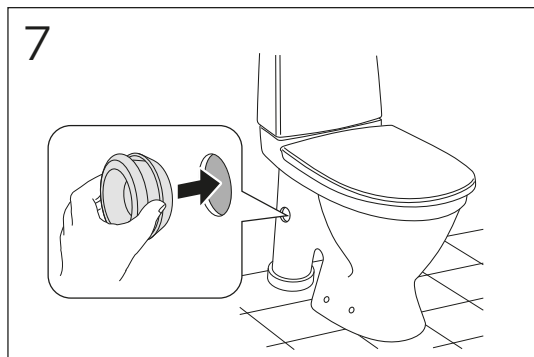
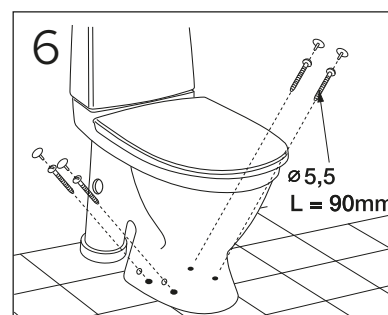
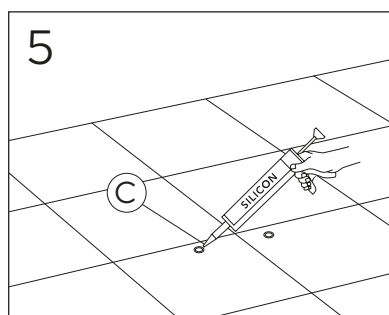
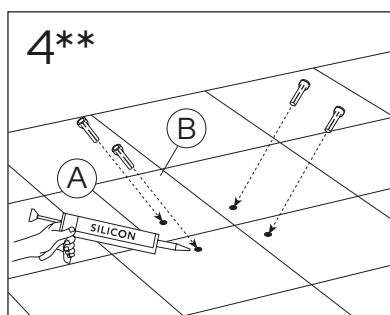
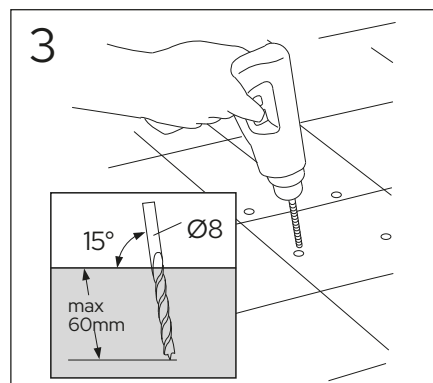
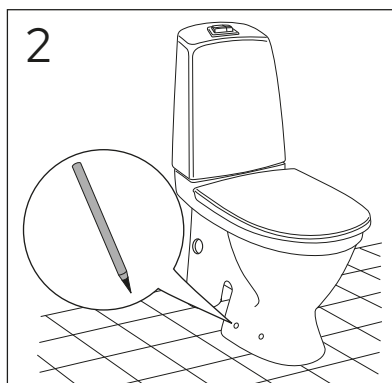
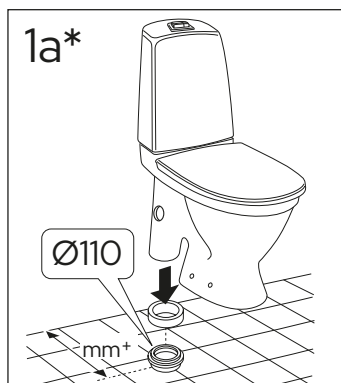
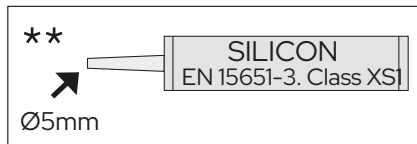

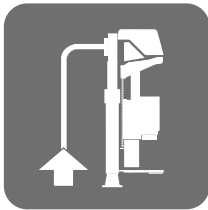
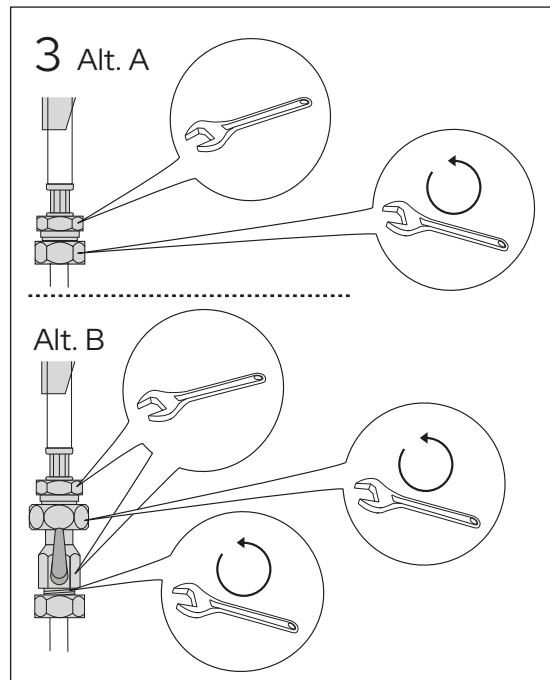
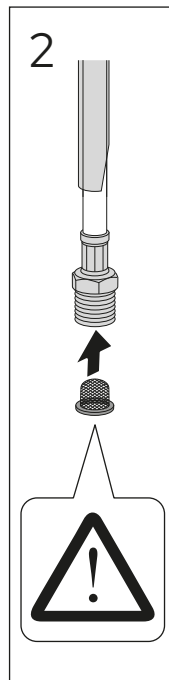
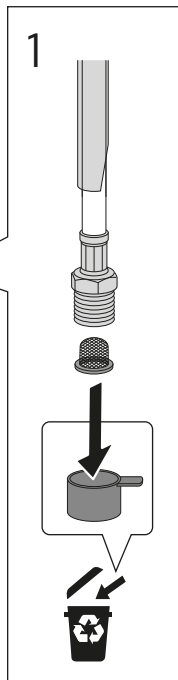
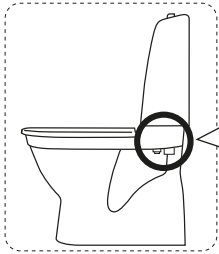

Operating pressure, fill valve 0,5-10 bar  
Drifttryck, påfyllningsventil, 0,5-10 bar

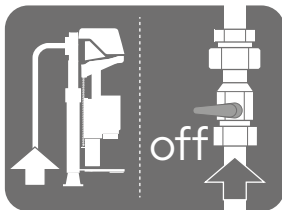

Pressure test (water), fill valve.  
Provtryckning (vatten), påfyllningsventil Max 10 bar.  
Pressure test (water) shut off valve, GB1921100503.  
Provtryckning (vatten) mot stängd avstängningsventil,  
GB1921100503 Max 16 bar.

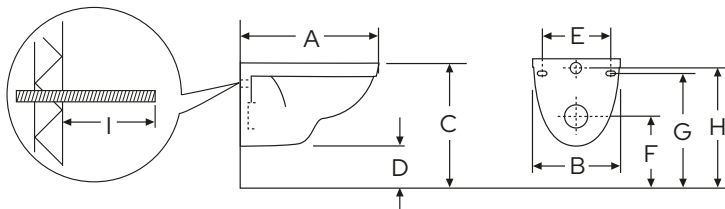
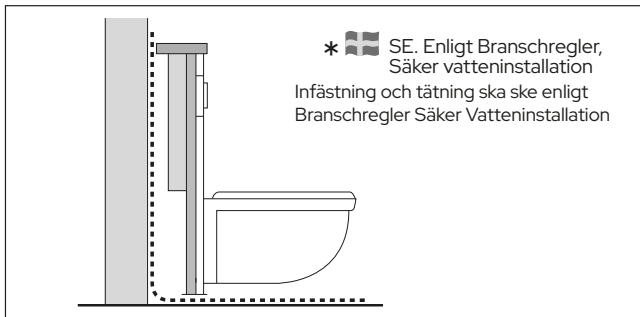

Models	A	B	C	D	E	F	G	H	I
5530	500	340	400	45	180/230	220	320	355	60
1530	510	350	400	50	180/230	220	320	355	35



## NAUTIC 5530

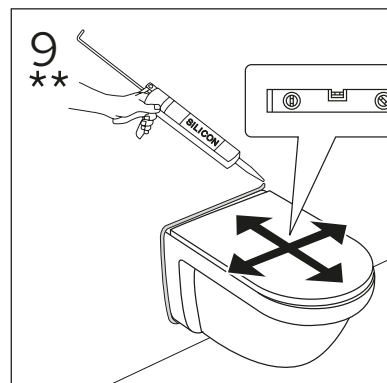
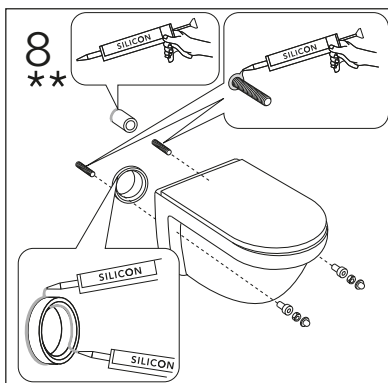
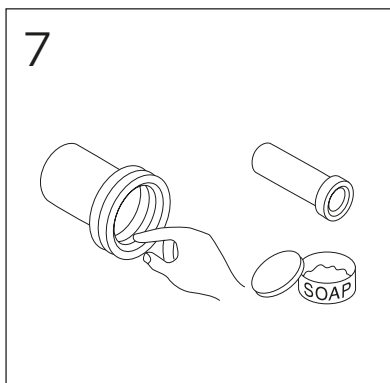
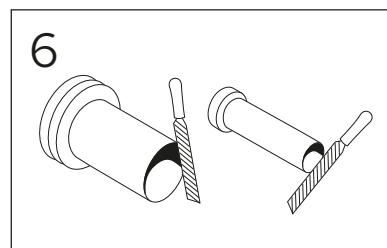
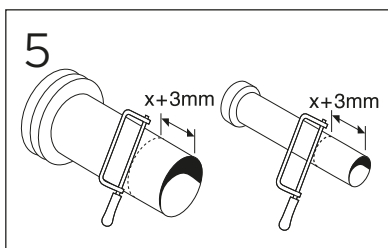
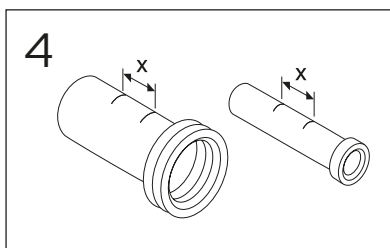
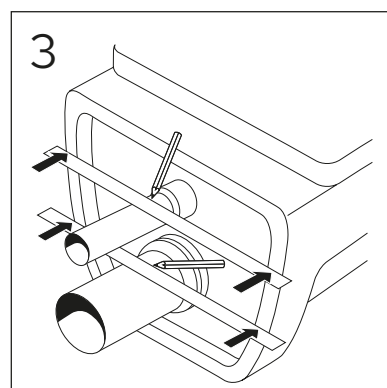
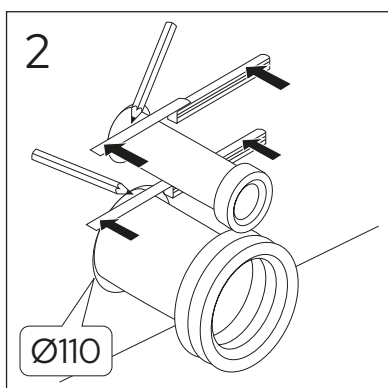
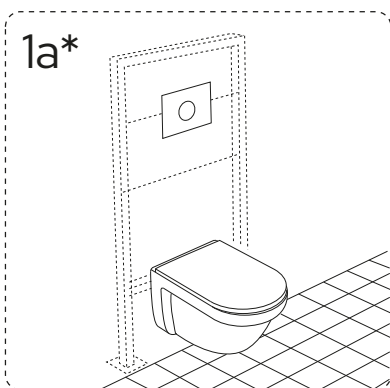
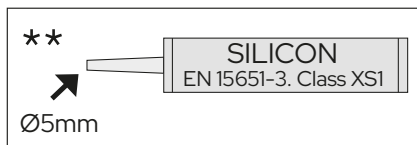



## NAUTIC 1530

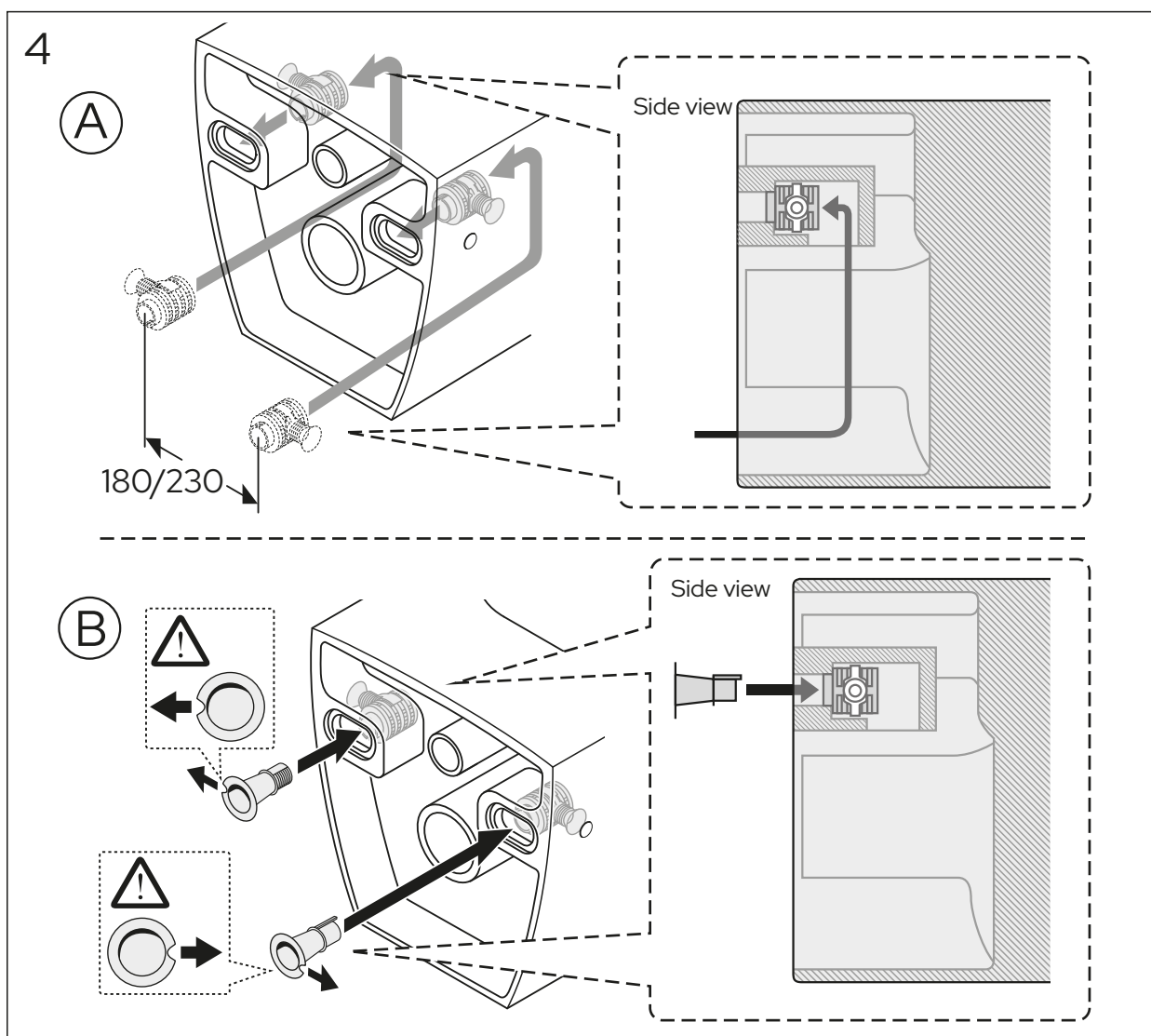
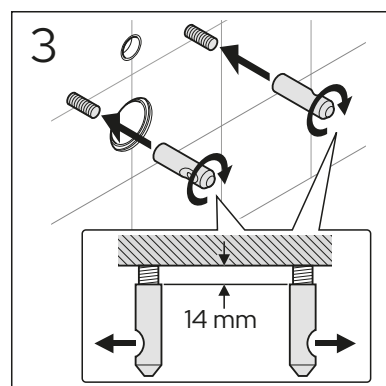
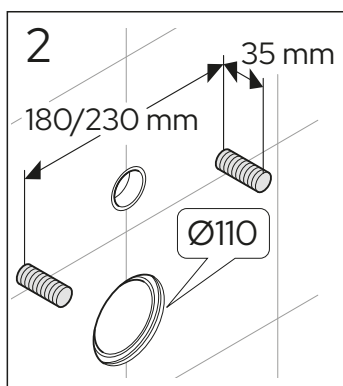
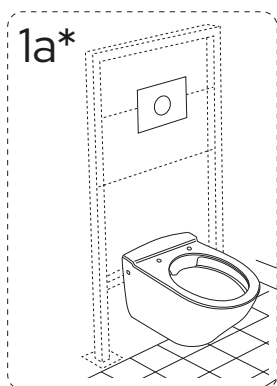
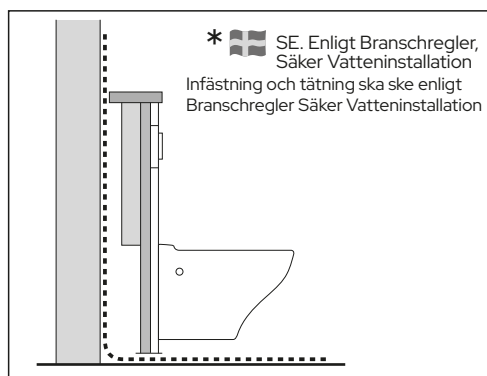

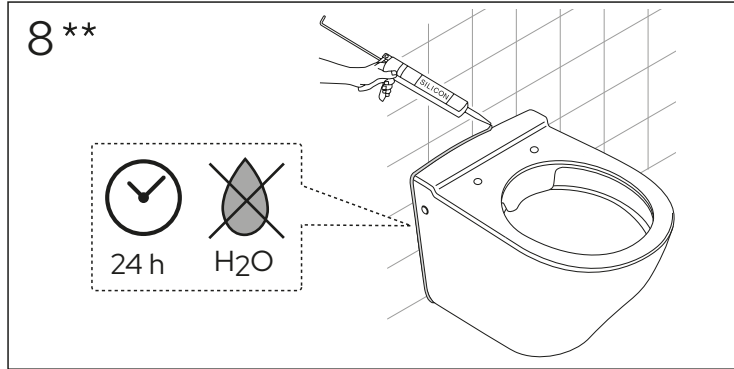
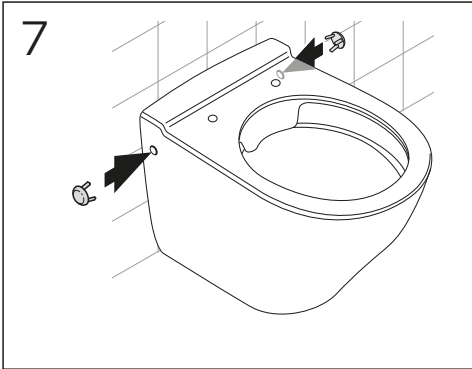
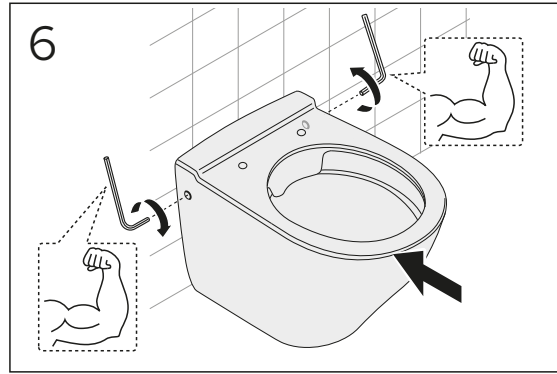
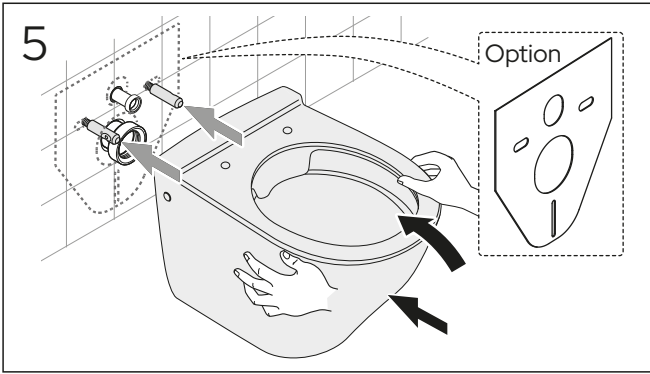



NAUTIC 1522

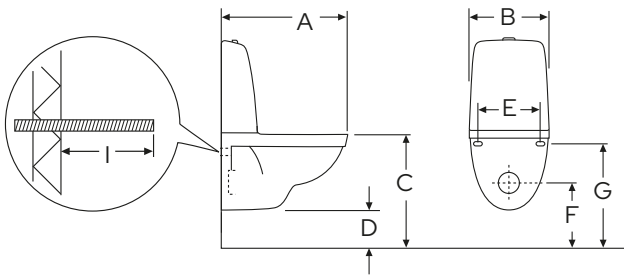
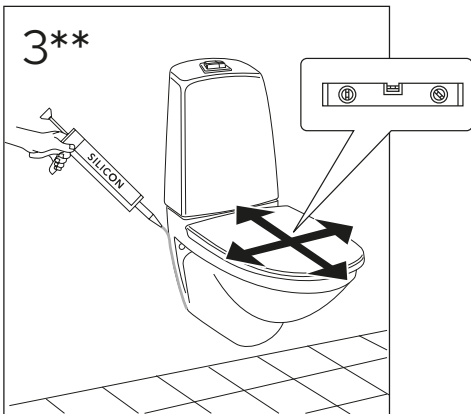
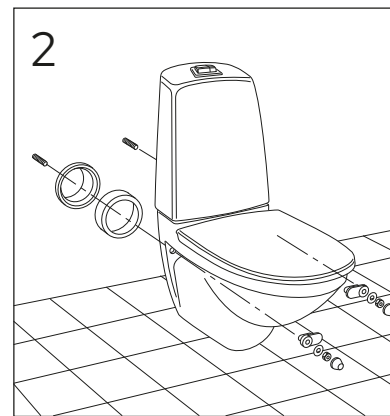
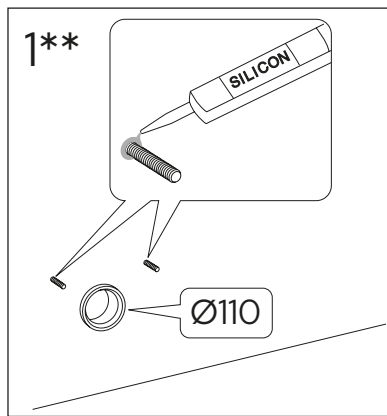
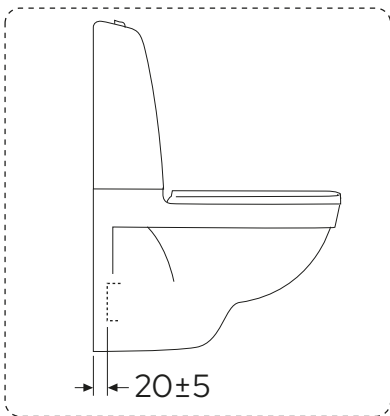
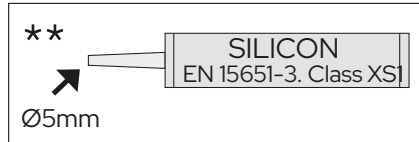

Models	A	B	C	D	E	F	G	I
1522	700	345	400	50	180/230	220	320	60



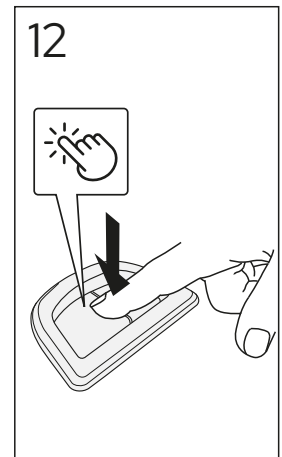
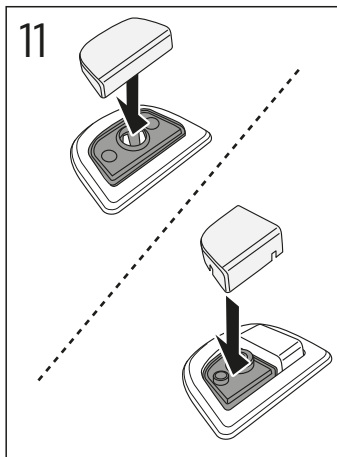
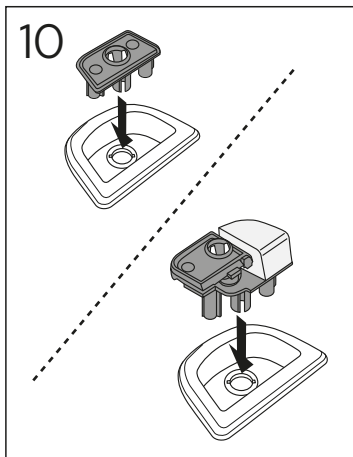
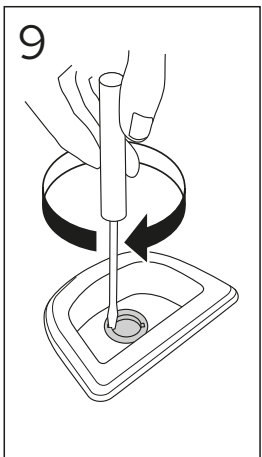
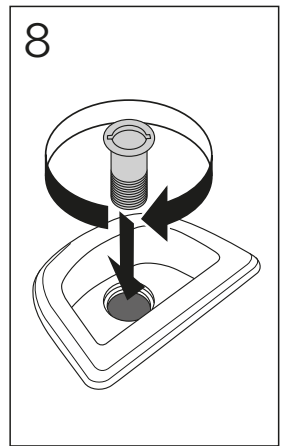
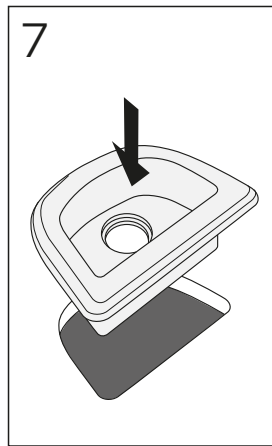
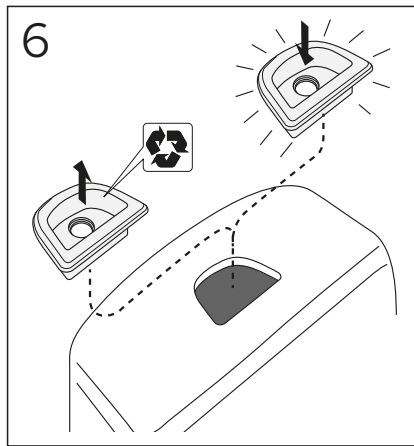
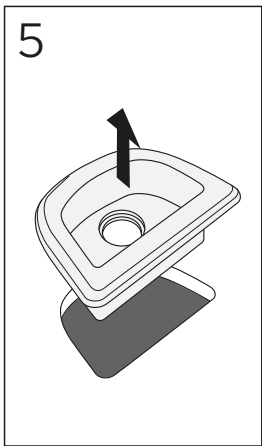
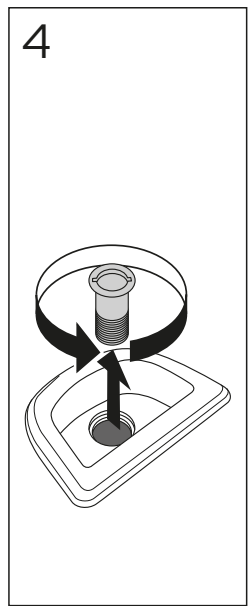
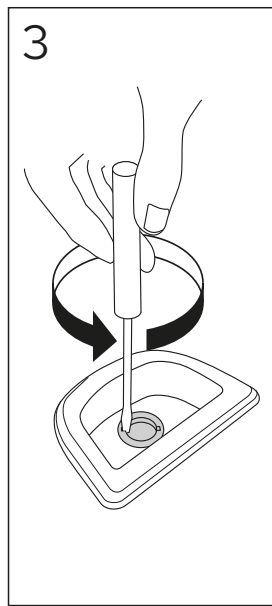
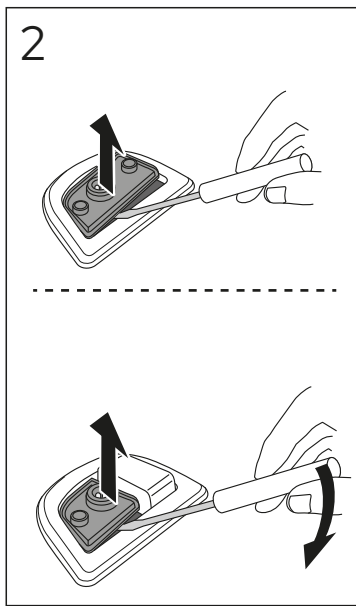
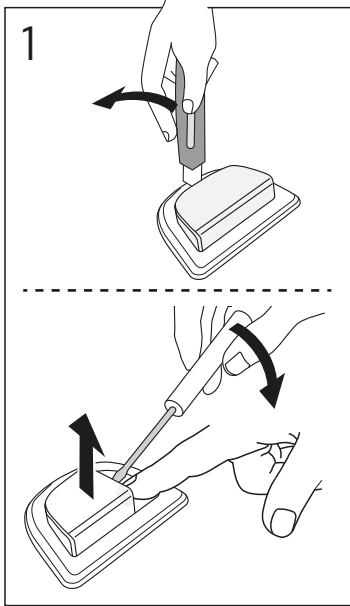
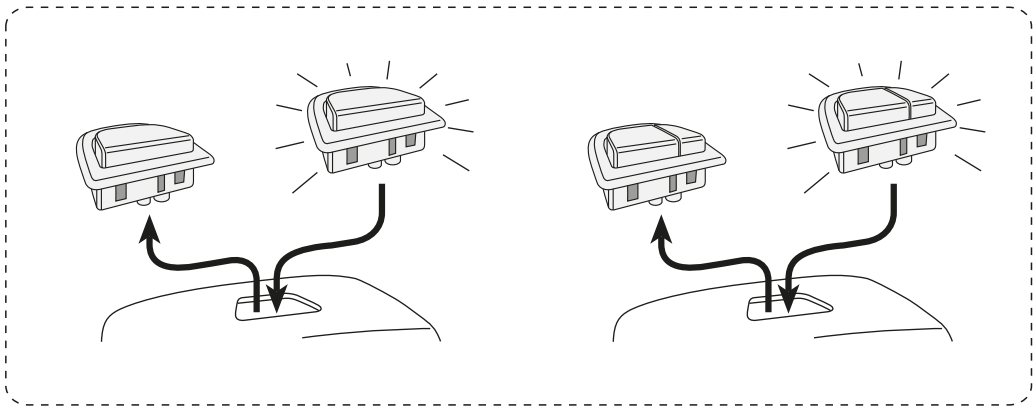

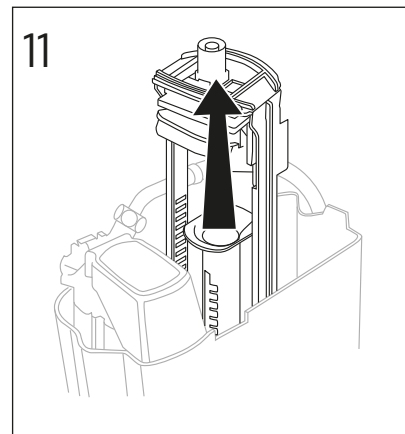
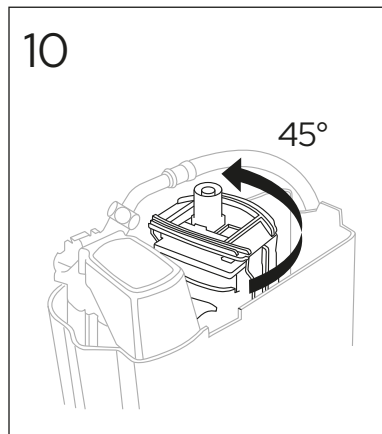
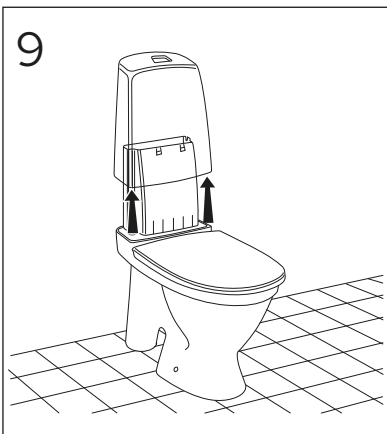
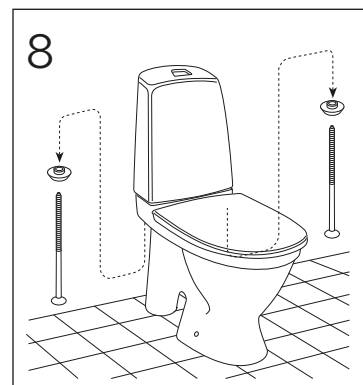
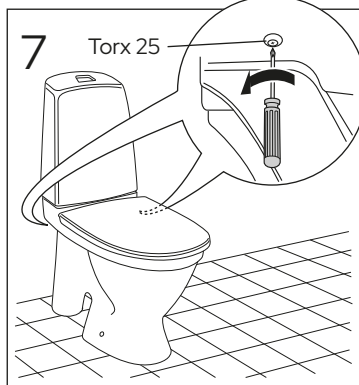
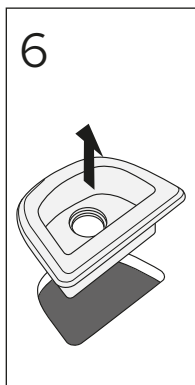
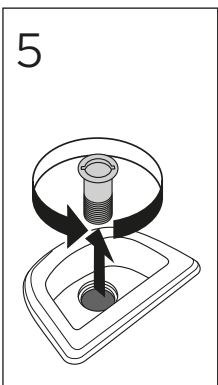
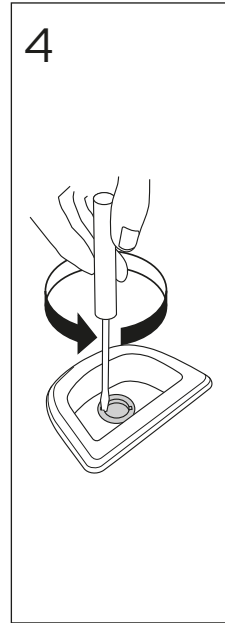
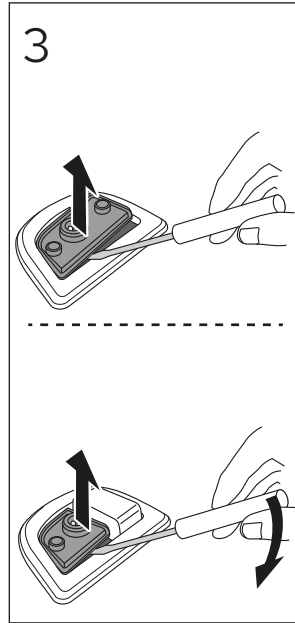
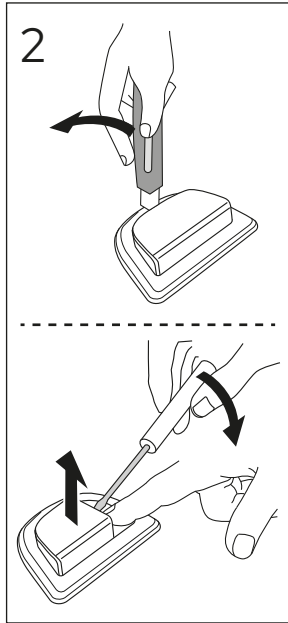
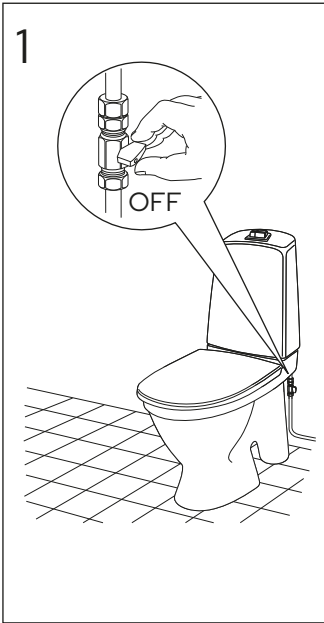
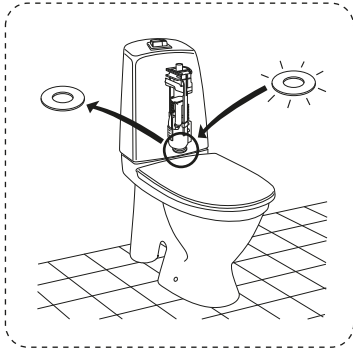

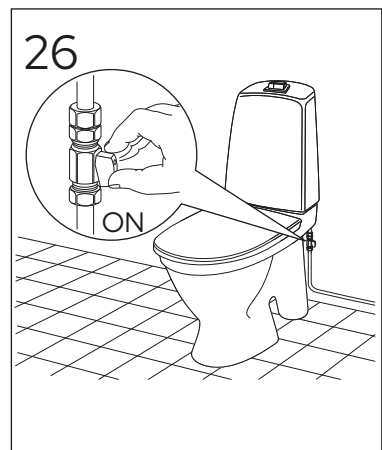
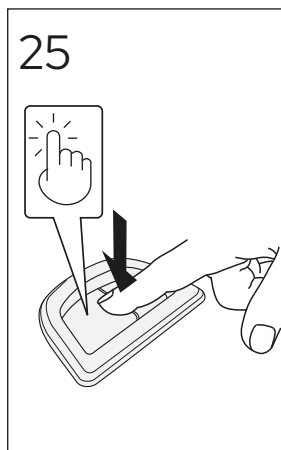
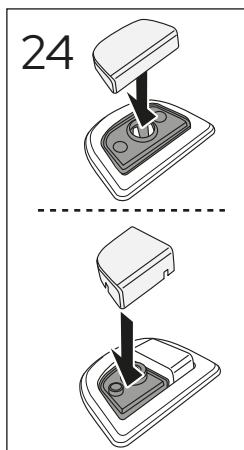
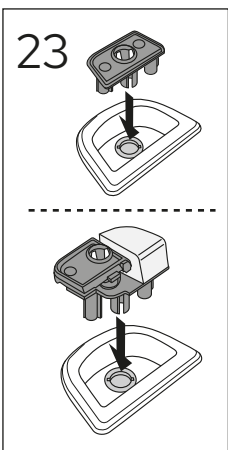
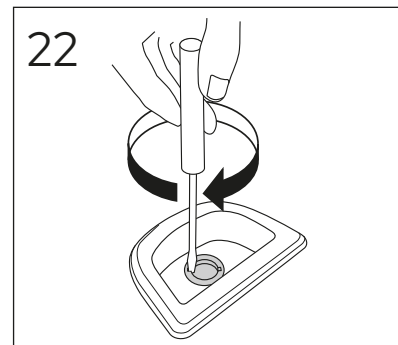
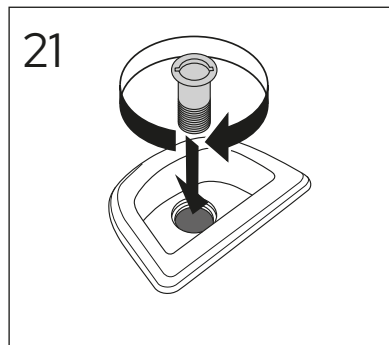
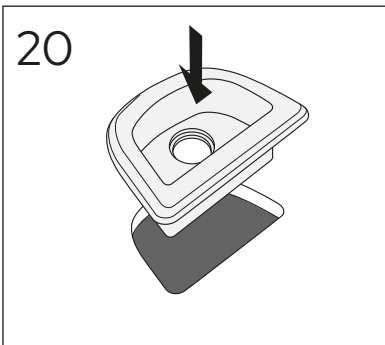
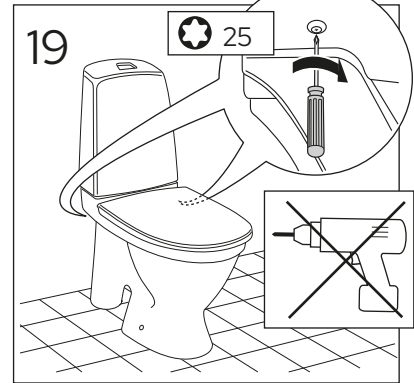
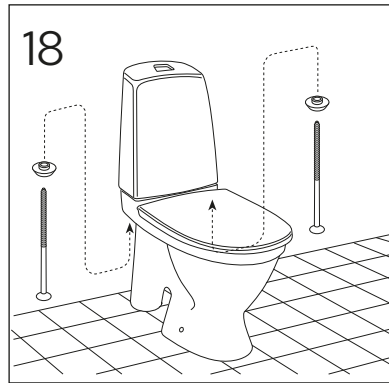
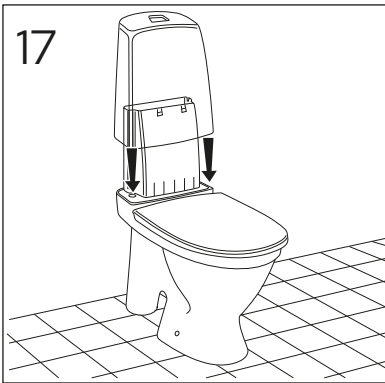
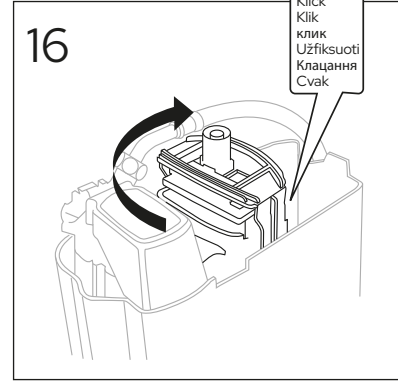
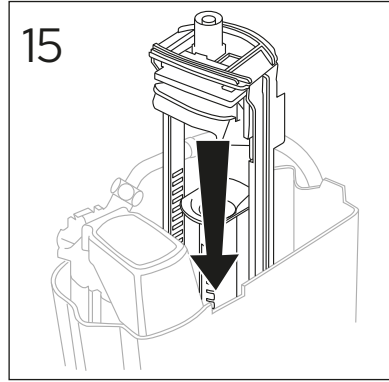
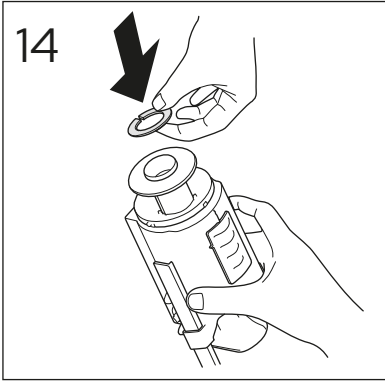
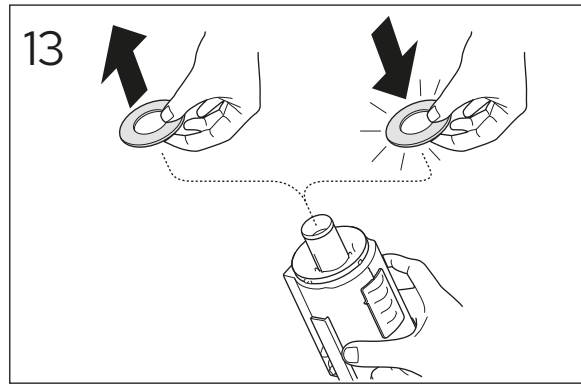
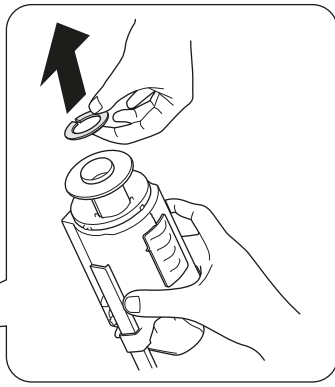
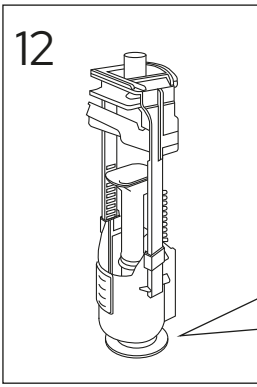

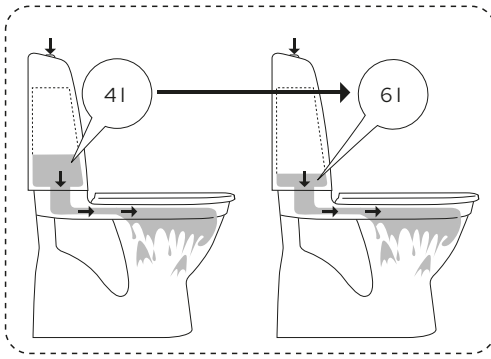

### Factory settings / Fabriksinställningar

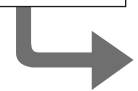
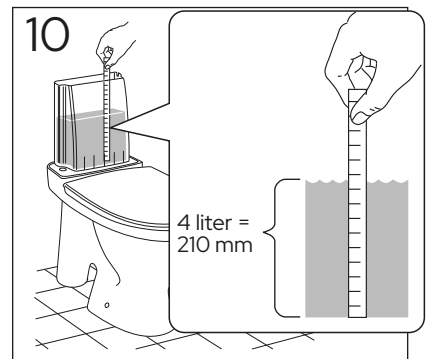
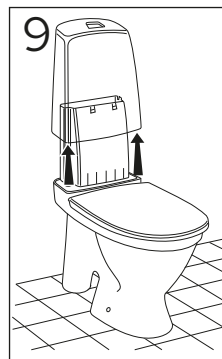
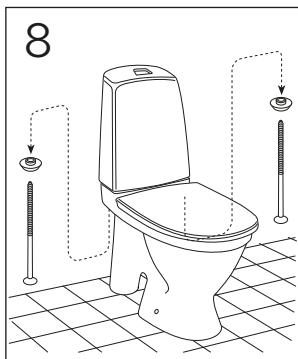
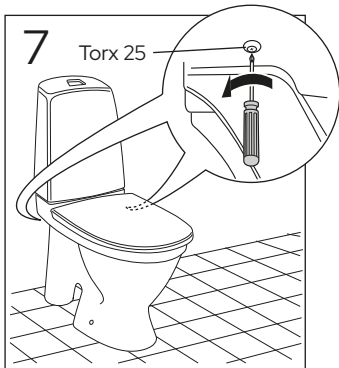
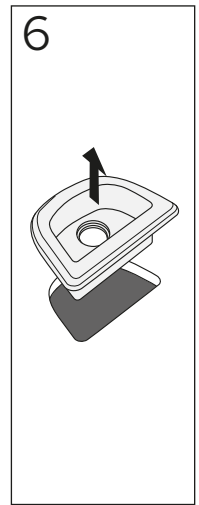
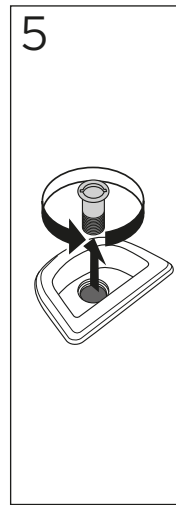
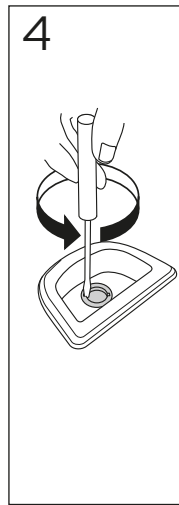
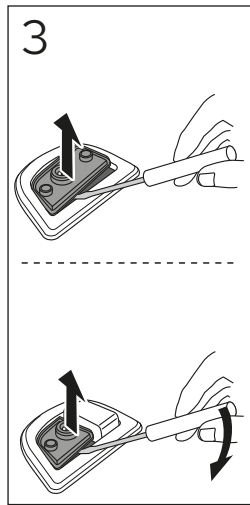
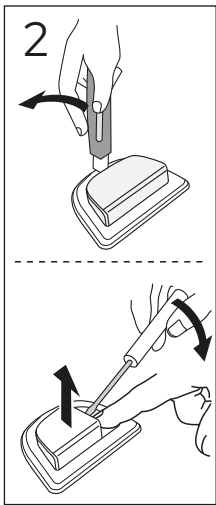
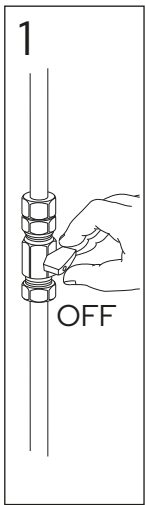
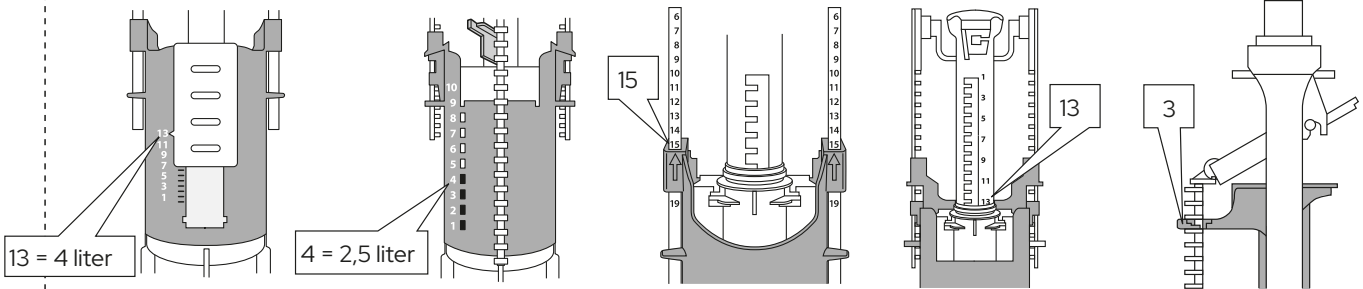

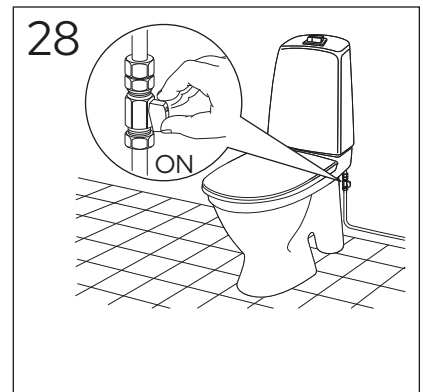
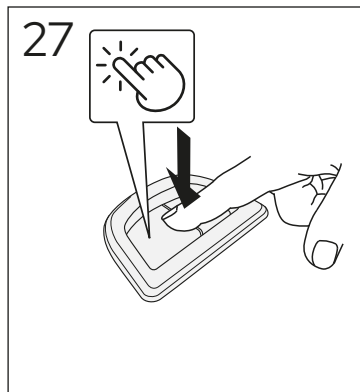
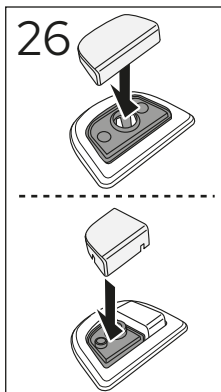
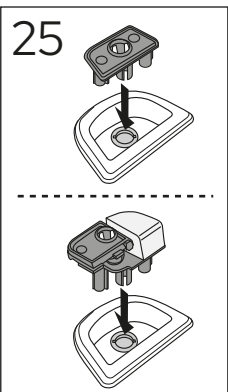
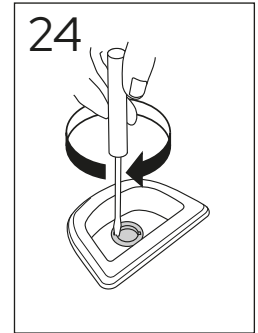
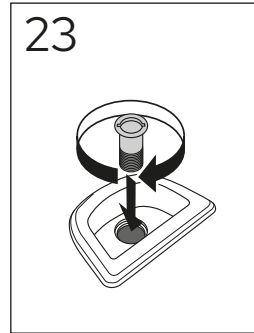
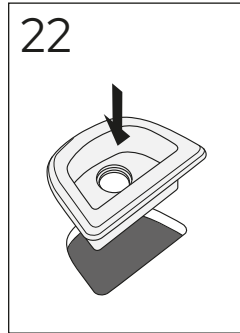
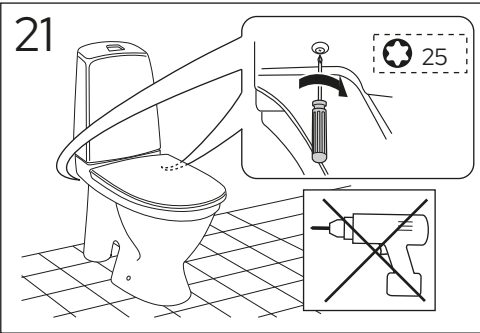
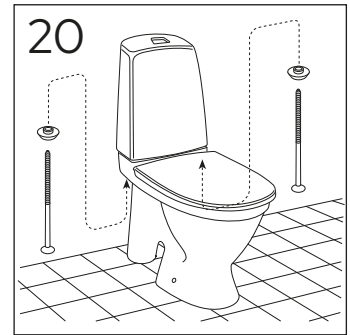
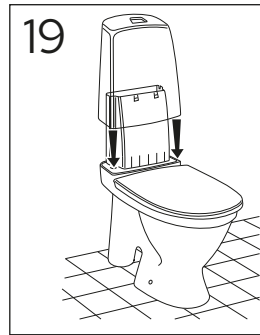
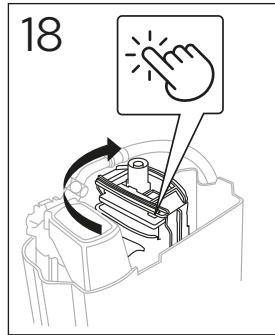
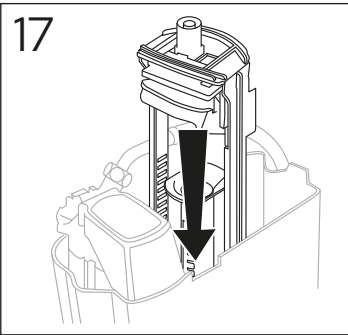
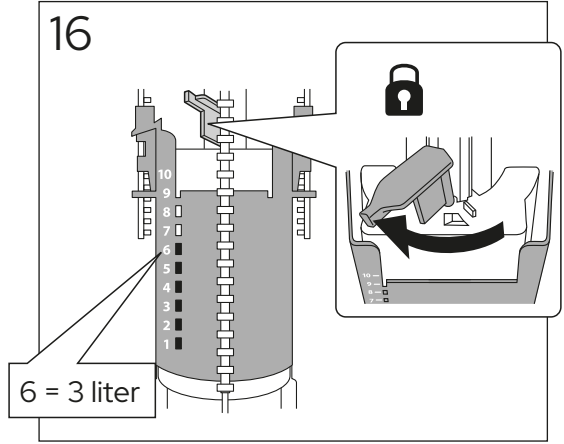
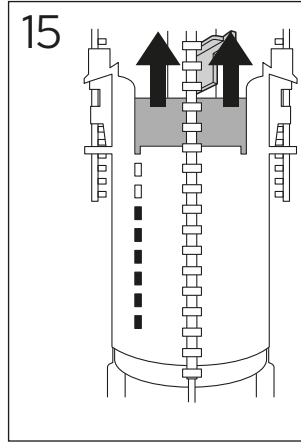
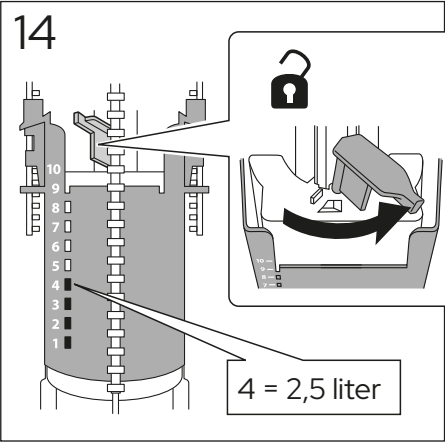
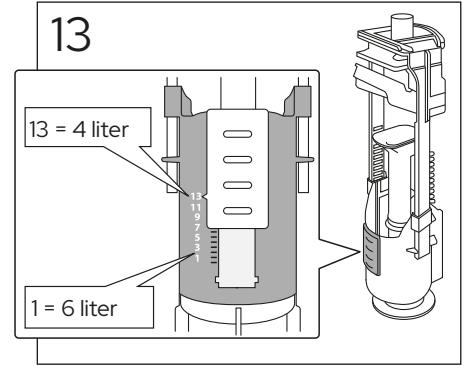
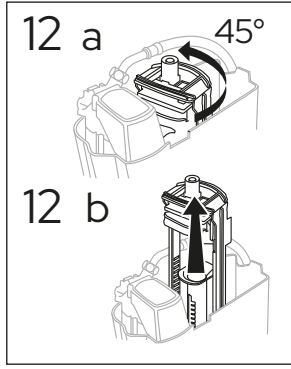
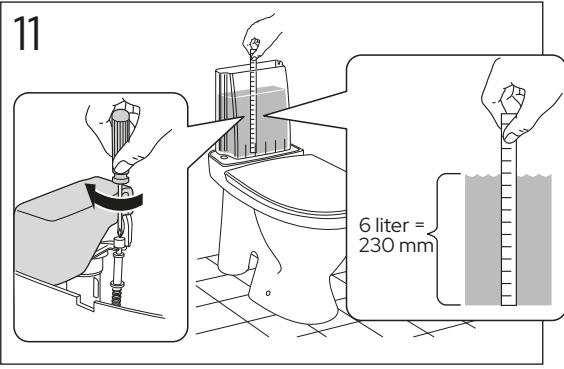

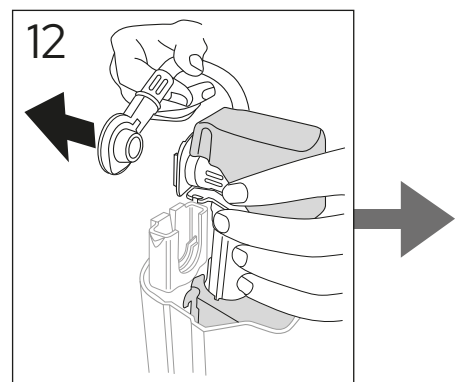
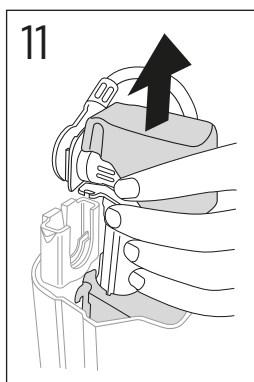
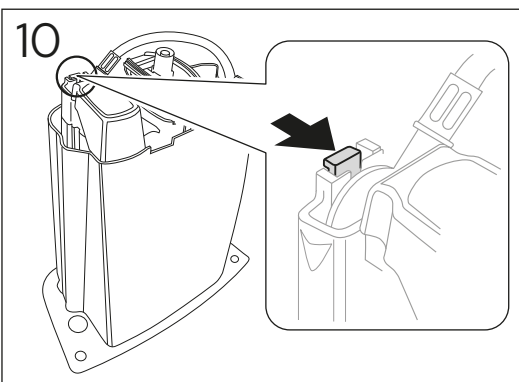
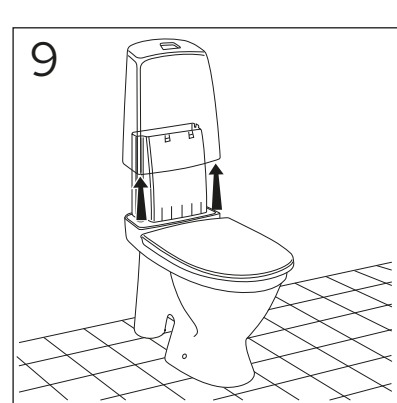
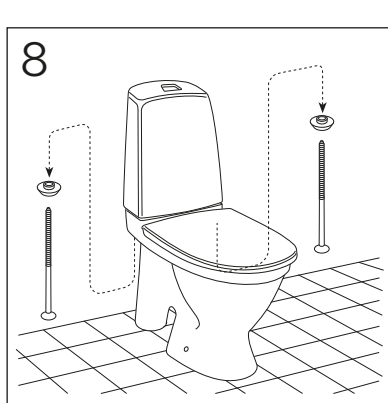
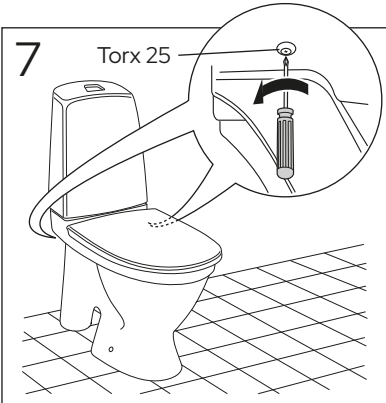
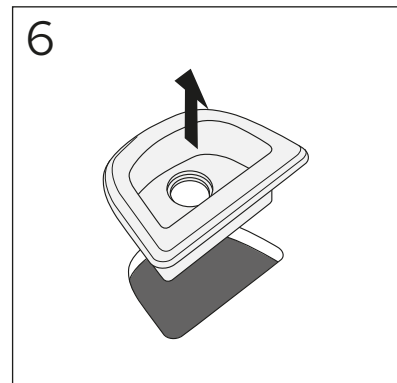
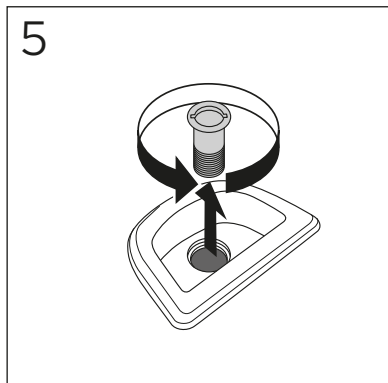
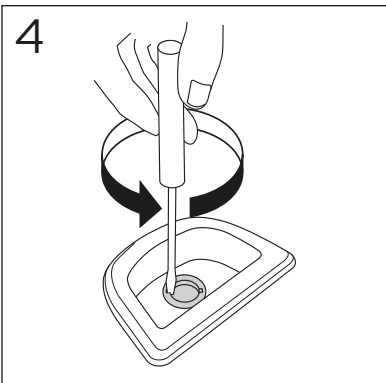
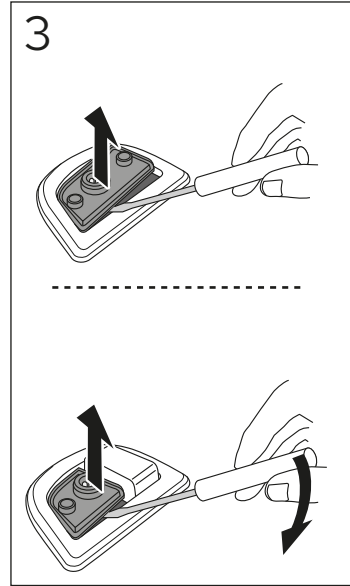
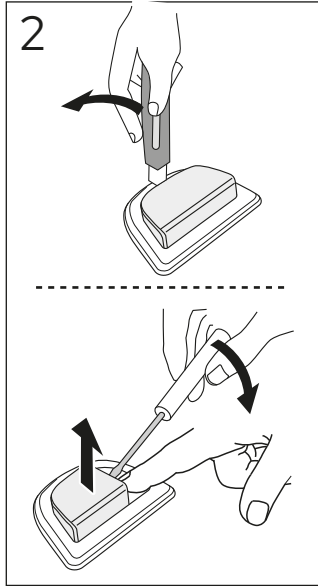
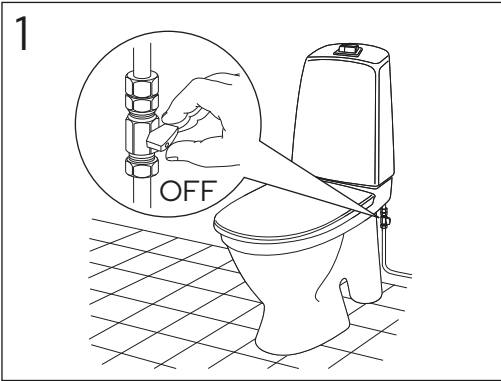
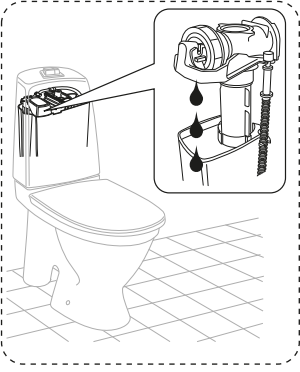

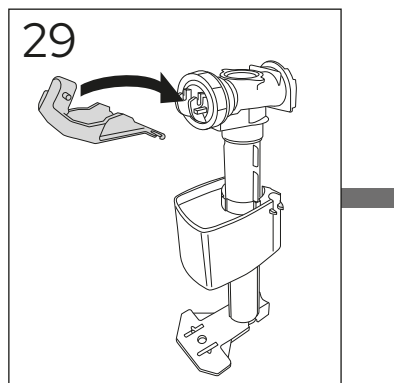
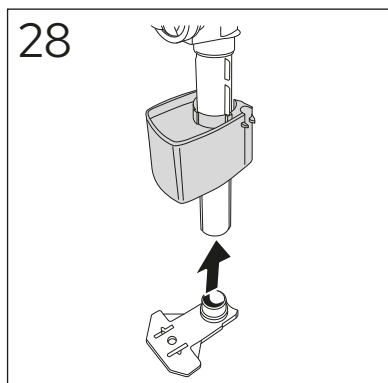
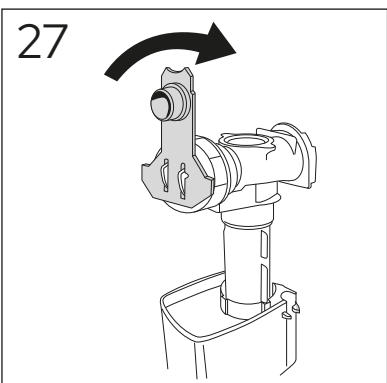
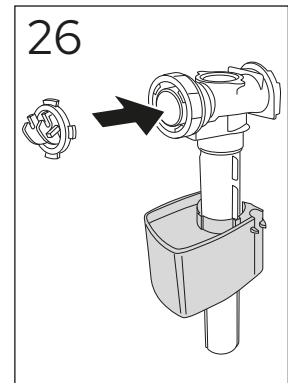
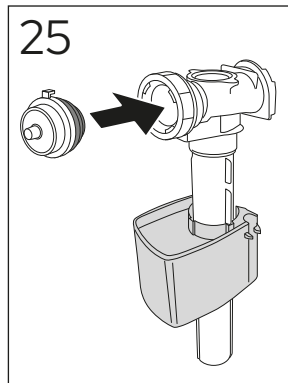
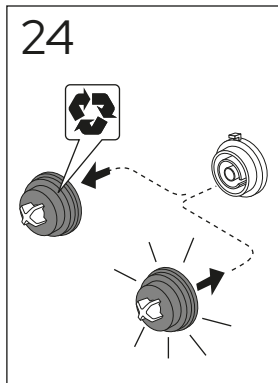
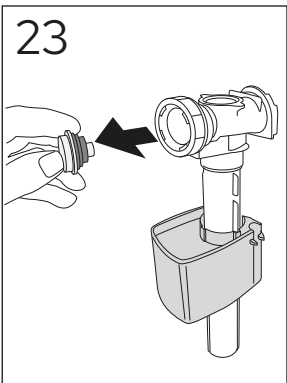
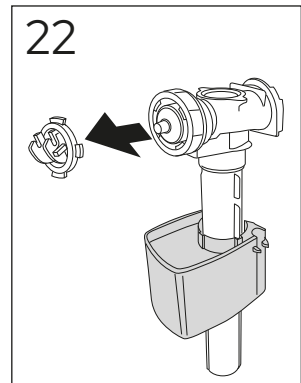
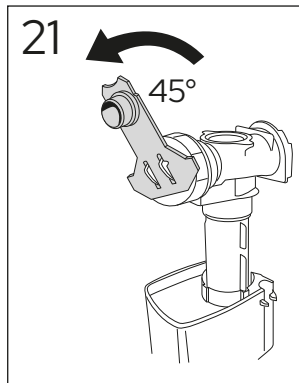
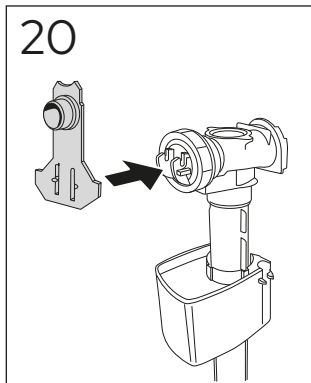
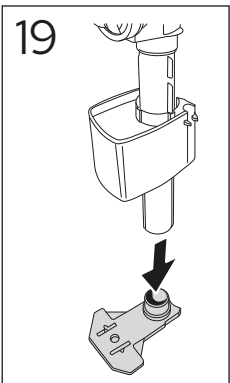
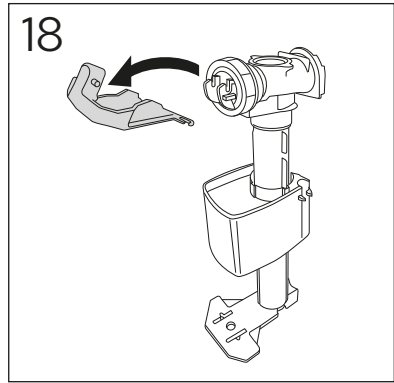
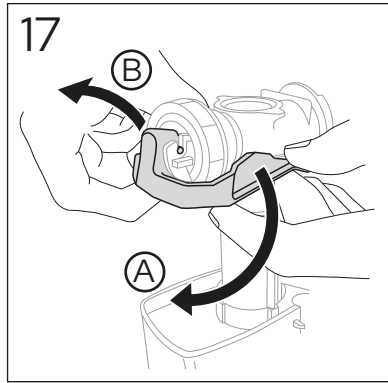
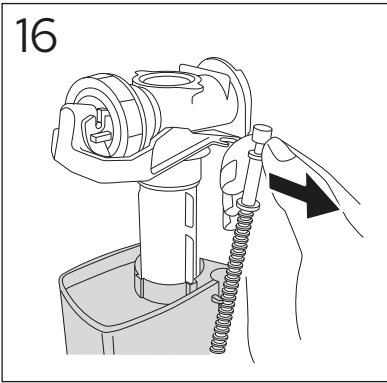
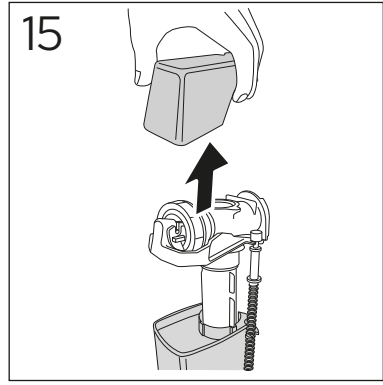
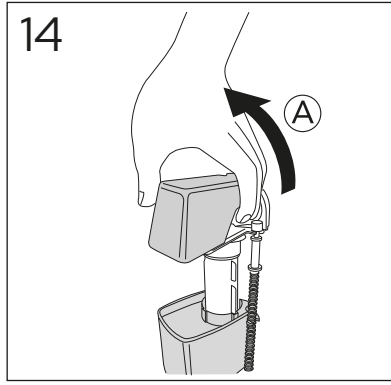
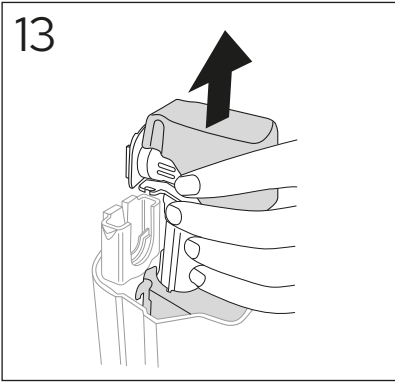

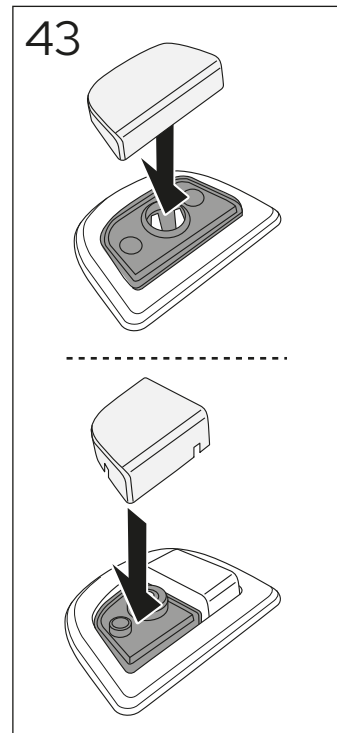
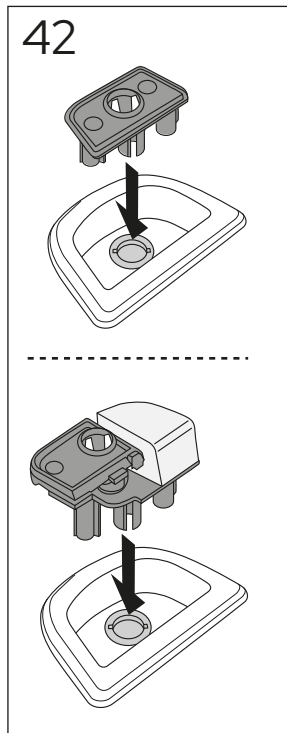
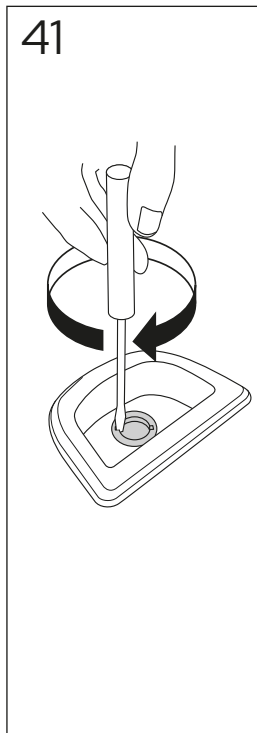
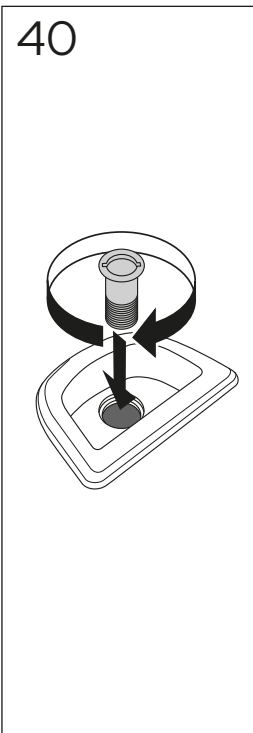
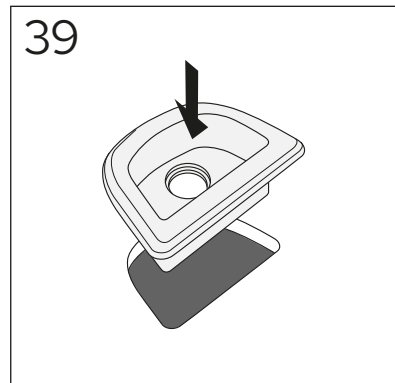
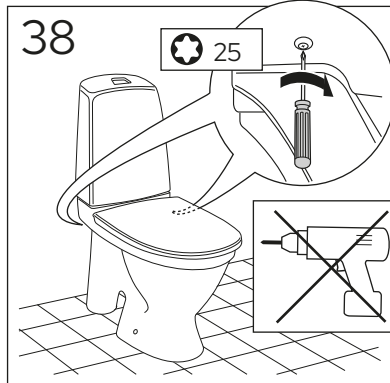
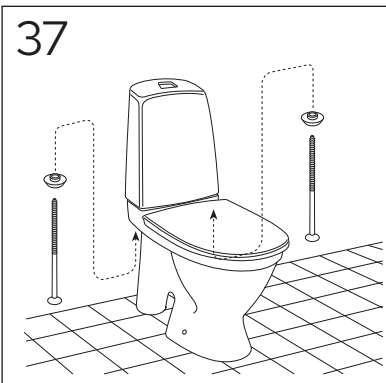
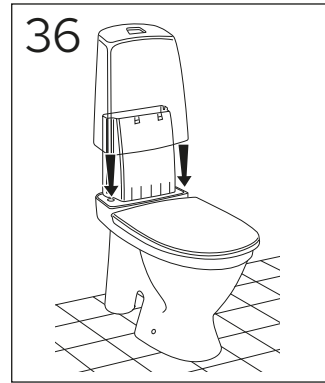
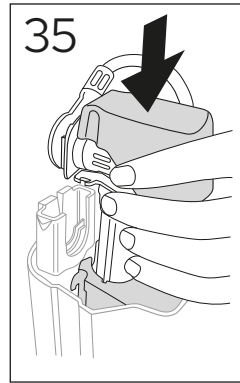
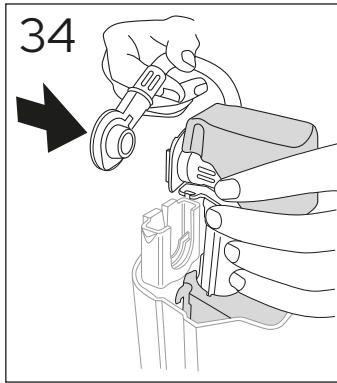
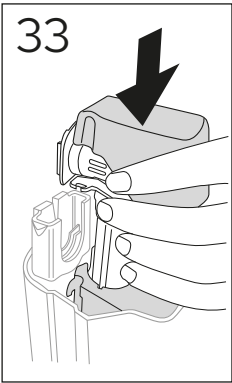
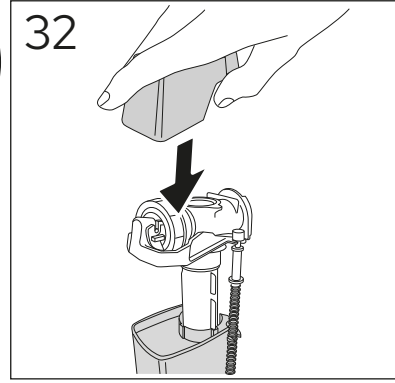
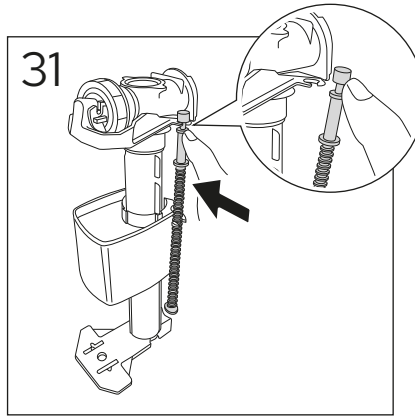
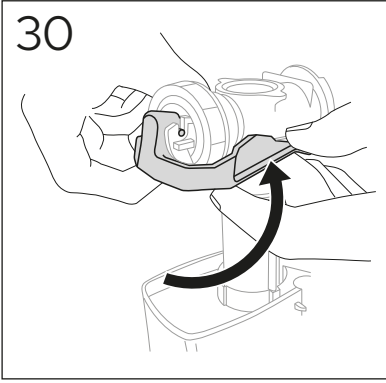

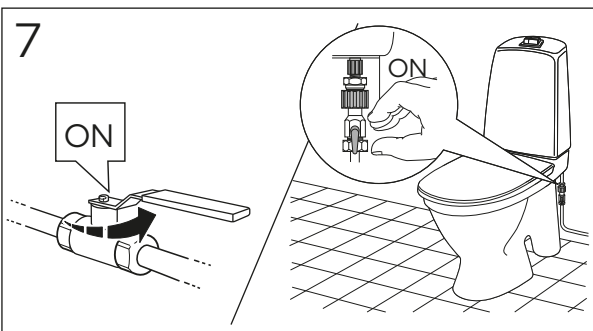
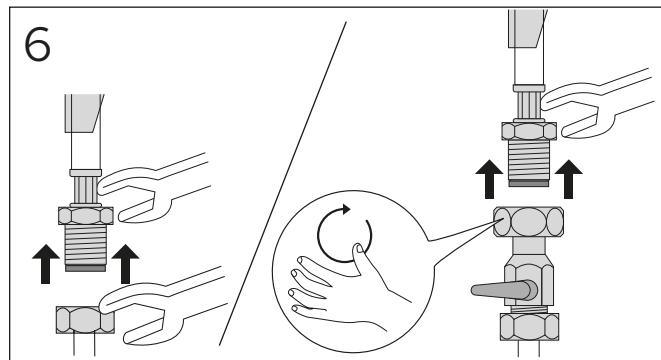
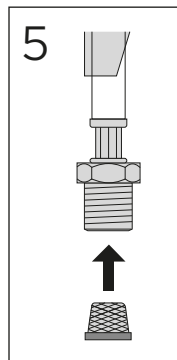
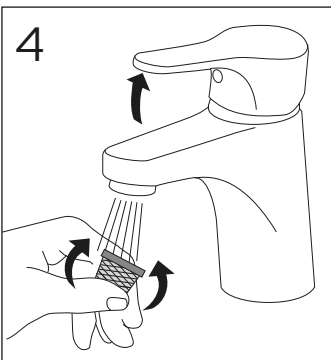
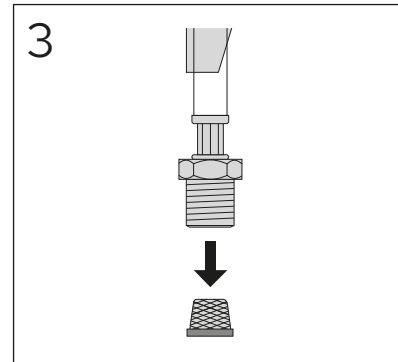
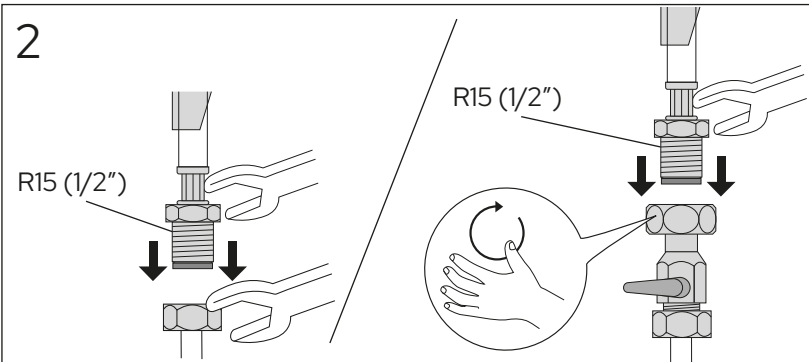
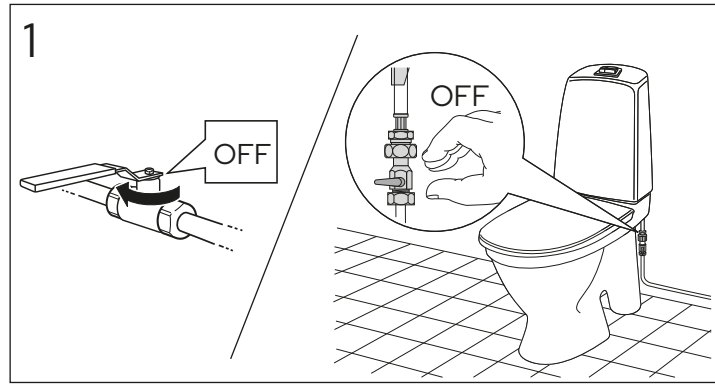
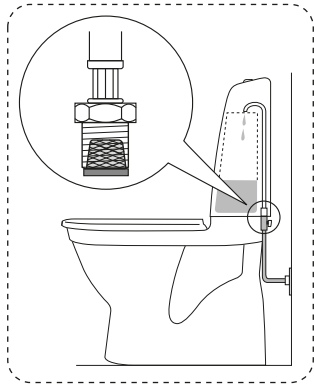
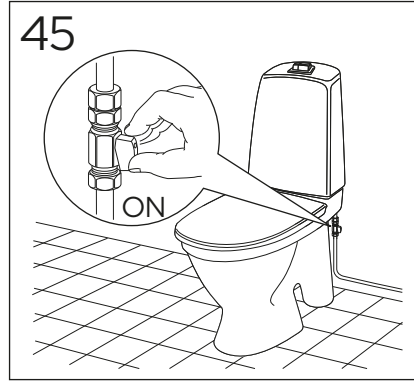
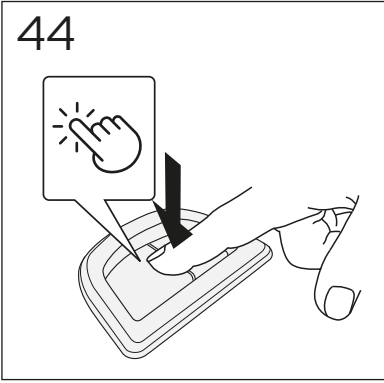



9M26S101. 9M26S136. 8M45S101. 9M256101.  
8M916101. 8M91S101. 8M93S101 & 8M93S115.

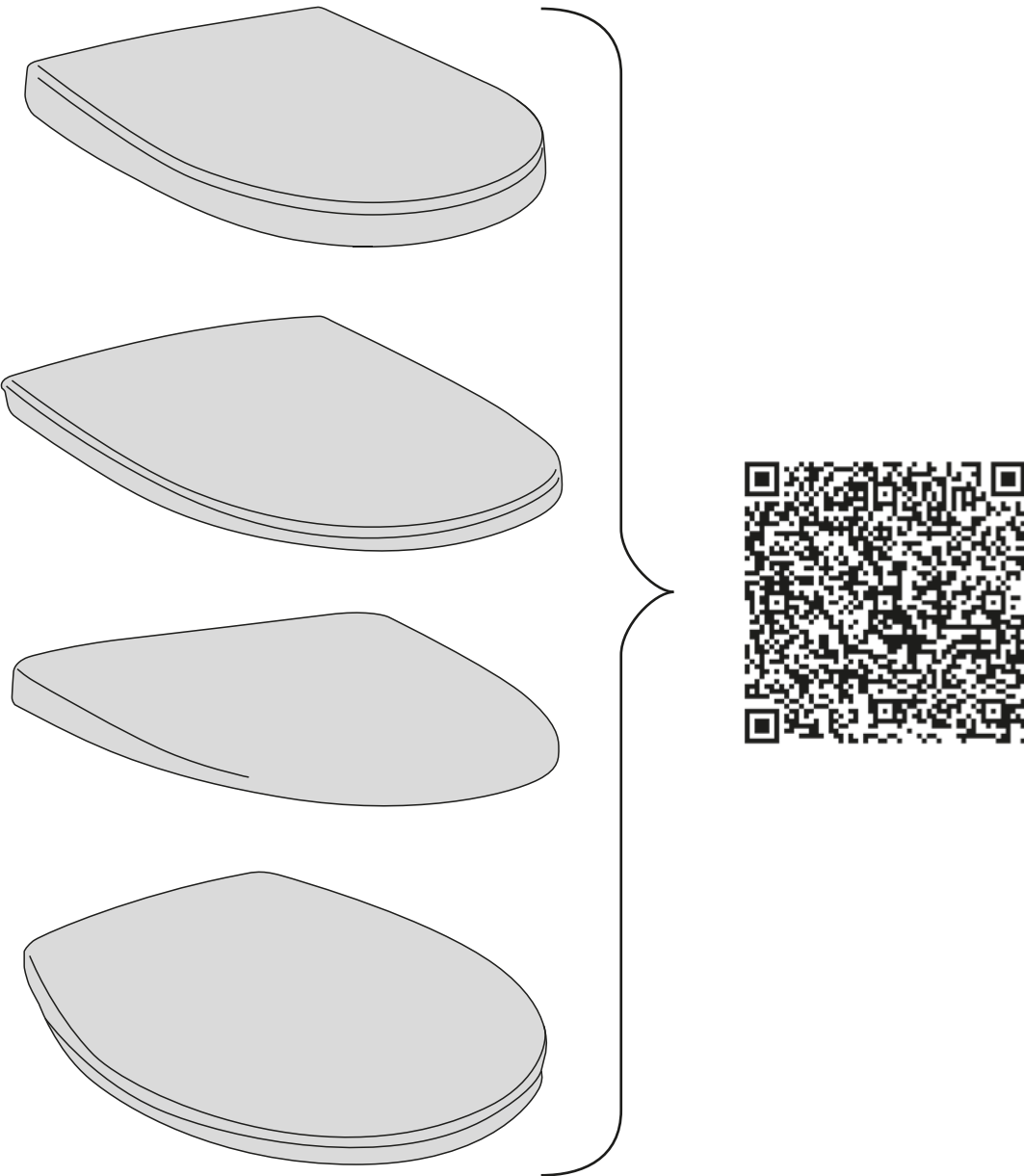



RESERVDELAR.  
RESERVEDELER.  
RESERVEDELE.  
VARAOSAT.  
SPARE PARTS.  
VARUOSAD.  
ATSARGINĒS DALYS.  
REZERVES DAĻAS.



DRIFT & SKÖTSEL  
DRIFT OG VEDLIGEHODELSE  
DRIFT OG VEDLIKEHOLD  
ASENNUS-, KÄYTTÖ- JA HOITO-OHJEET  
ASSEMBLY AND MAINTENANCE  
PAIGALDAMINE & HOOLDAMINE  
MONTAZA UN KOPSANA  
MONTAVIMAS IR PRIEŽIURA



Sweden  
Gustavsberg AB  
Odelbergs väg 11  
134 46 Gustavsberg

Norway  
Gustavsberg AS  
Smeltingen 1  
0195 Oslo

Denmark  
Gustavsberg A/S  
Hobrovej 2  
2610 Rødovre

Finland  
Gustavsberg Oy  
Linnoitustie 6d  
02600 Espoo

Estonia  
Gustavsberg OY Esti Filialal  
F.R. Faehlmanni 6  
10125 Tallinn

Latvia  
Gustavsberg OY Latvijas Filiale  
Roberta Hirsā ielā 1, office 303  
LV-1045 Rīga

Lituania  
Gustavsberg OY filialas  
Polocko 28B-1  
Vilnius, LT 01205

