

Bidé mixer New Nautic

With waste valve and lift bar

GUSTAVSBERG /
SMARTER BATHROOMS



Product features

Quick fit



- All components made in food approved materials
- Ball-jointed aerator directs the water flow
- Easy grip lever with clear colour marking for hot and cold

Article number etc.

RSK-nr:

ART-nr:

EAN-nr:

GB41216071

7393792235563

Packaging

L: 225,00 x W: 205,00 x H: 70,00 mm.

Weight: 1,20 kg

Energy labeling and certifications



Denna produkt är anpassad till
Branschregler SÄKER Vatteninstallation
2021:1. Leverantören garanterar
produktens funktion om branschreglerna
och monteringsanvisningarna följs.



Assembling & Care

Prior to installation the lines must be flushed up to the faucet. The faucet is connected with the cold water line on the right and the hot water line on the left. Water pressure: max 1000 kPa, min 50kPa. Hot water temperature: max 70°C, min 45°C. Please note that we are not liable for damage resulting from improper installation.

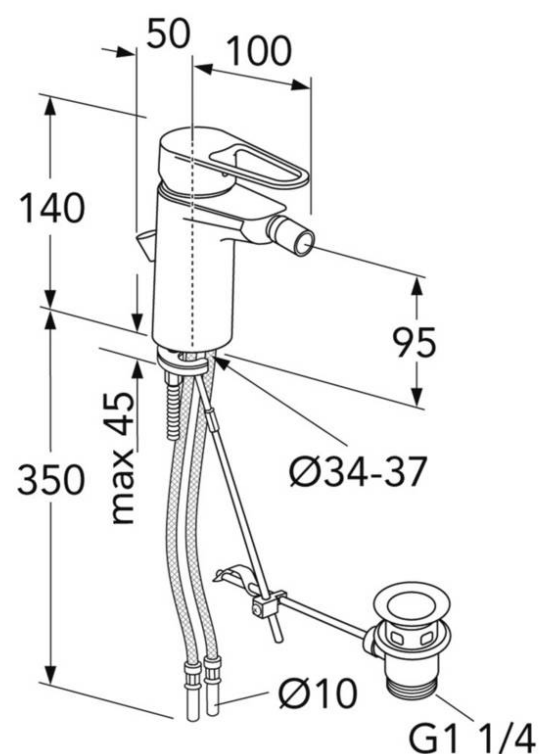

Villeroy & Boch Gustavsberg AB / Box 400, 134 29 Gustavsberg, Sweden / Tel: +46 (0) 8-570 391 00 | Fax +46 8 570 320 36 /

www.gustavsberg.com / info@gustavsberg.com